

Chevrolet

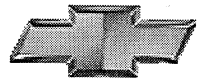

Tracker



2000

Table of Contents

Product Information	9
2000 Tracker — The Perfect Blend Of Refinement And Ruggedness	9
Rugged Exterior Styling.....	9
Nimble, Agile, Stand-and-Deliver Performance	9
SUV Durability and Strength	9
Wide Open Room and Comfort.....	10
Brand Identity.....	11
What's New And Highlights.....	11
Exterior	11
2.0-Liter DOHC Engine	11
Shift-On-The-Fly 4WD System.....	11
Full-Length Ladder-Type Frame	11
Marketplace.....	11
Model Summary.....	11
Competitors.....	11
Two-Door:.....	11
Four-Door:	12
Buyer Demographics	12
Two-Door.....	12
Four-Door	12
Vehicle Overview.....	13
Interior Overview.....	13
Key Standard Features*.....	13
Tracker Two-Door Convertible Model:.....	13
Tracker Four-Door Model Adds The Following Equipment, In Addition To Or In Place Of Two-Door Convertible:.....	13
Key Optional Features*	13
Exterior/Structural Overview	14
Key Standard Features*	14
Tracker Two-Door Convertible Model:.....	14
Key Optional Features*	14
Exterior Paint.....	14
Paint Colors	14
Convertible Top Colors:.....	15
Functional Overview	15
Key Standard Features*.....	15
Tracker Two-Door Convertible Model:.....	15
Tracker Four-Door Model Adds The Following Equipment, In Addition To Or In Place Of Two-Door Convertible Models:	15
Key Optional Features*	15
Optional Packages	15
Optional Accessory Packages Include:	15
Safety And Security*	15
Crash Avoidance Features	15
Occupant Protection Features	16
Security Features.....	16
Sound Systems	16
Tracker Two-Door Convertible and Tracker Four-Door.....	16
Seats	17
Tracker Four-Door:	17
Interior Colors.....	17

Engineering.....	18
Engines	18
1.6-Liter SOHC 16-Valve L4 Engine (L01).....	18
Power Ratings For The 1.6-Liter Engine:	18
Technical Features Of This Engine:	18
2.0-liter DOHC 16-Valve L4 Engine (L34).....	18
Power Ratings For The 2.0-Liter Engine:	18
Technical Features Of This Engine:	18
Transmissions.....	19
Five-Speed Manual Transmission With 5th-Gear Overdrive	19
Four-Speed Automatic Transmission.....	19
Suspension	19
Front	19
Rear	19
Steering.....	19
Brakes	19
Wheels And Tires.....	20
Wheels	20
Tires	20
Feature Availability	21
Interior	21
Exterior.....	21
Functional.....	21
Specifications.....	23
Model Availability	23
Specifications & Capacities.....	23
Exterior Dimensions	23
Interior Front Dimensions.....	23
Interior Rear Dimensions.....	23
Capacities.....	23
Steering.....	24
Brakes	24
Engines	24
Transmissions.....	24
Chassis	25
Chassis.....	25
Suspension - front	25
Suspension - rear	25
Mileage/Performance*	25
Trailer Information	26
Wheels & Tires.....	26
Vehicle Identification.....	27
Vehicle Identification Number (VIN).....	27
VIN Derivative	28
Label - Vehicle Certification	28
Tire Placard.....	29
Service Parts Identification Label (SPID).....	30
SPID Label Location.....	30
Engine ID and VIN Derivative Location 1.6L	31
Engine ID and VIN Derivative Location 2.0L	32
Transmission ID and VIN Derivative Location	33
Manual Transmission	33
Automatic Transmission	34

Engine and Transmission Usage	34
Labeling - Anti-Theft	35
RPO Code List	36
Technical Information	38
Maintenance and Lubrication	38
Drive Belt Tension Specifications	38
Capacities - Approximate Fluid	38
4-Speed Automatic Transmission (RPO M41)	38
5-Speed Manual Transmission (RPO M59)	38
Axle Housing	38
Cooling System Capacity	38
Engine Crankcase	38
Fuel Tank	38
Maintenance Items	39
Tire Inflation Pressure Specifications	39
Fluid and Lubricant Recommendations	40
Descriptions and Operations	41
Power Steering System Description and Operation	41
Power Steering Gear Description	41
Power Steering Pump Description	41
Steering Wheel and Column - Standard Description and Operation	42
Vehicle Steering	42
Vehicle Security	42
Driver Convenience	42
Driver Safety	42
Suspension Description and Operation	43
Front Suspension	43
4WD Front Suspension Sectional View(c)	43
2WD Front Suspension Sectional View(c)	44
Rear Suspension	45
Rear Suspension(c)	45
Rear Suspension and Rear Axle Sectional View(c)	46
Rear Suspension Side View(c)	47
Wheels and Tires	48
General Description	48
Tread Wear Indicators Description	48
Metric Wheel Nuts and Bolts Description	48
Tire Inflation Description	48
P-Metric Sized Tires Description	50
Driveline System Description and Operation	51
Driveline/Axle – Propeller Shaft	51
Front and Rear Propeller Shaft	51
Universal Joint Description	52
Wheel Drive Shafts	53
Front Drive Axle Description and Operation	53
Front Axle Operation	54
Rear Drive Axle Description and Operation	54
Rear Wheel Speed Sensor (ABS)	54
Transfer Case Description	55
Braking System Description and Operation	55

Hydraulic Brake System Description and Operation	55
System Component Description.....	55
Hydraulic Brake Master Cylinder Fluid Reservoir.....	55
Hydraulic Brake Master Cylinder.....	55
Hydraulic Brake Pressure Balance Control System	55
Hydraulic Brake Pipes and Flexible Brake Hoses	55
Hydraulic Brake Wheel Apply Components	55
System Operation.....	56
Brake Assist System Description and Operation	56
System Component Description.....	56
Brake Pedal	56
Brake Pedal Pushrod.....	56
Vacuum Brake Booster.....	56
Vacuum Source	56
Vacuum Source Delivery System	56
System Operation.....	56
Disc Brake System Description and Operation.....	56
System Component Description.....	56
Disc Brake Pads	56
Disc Brake Rotors.....	56
Disc Brake Pad Hardware	57
Disc Brake Caliper Hardware	57
System Operation.....	57
Drum Brake System Description and Operation.....	57
System Component Description.....	57
Drum Brake Shoes	57
Brake Drums.....	57
Drum Brake Hardware.....	57
Drum Brake Adjusting Hardware	57
System Operation.....	57
Park Brake System Description and Operation	58
System Component Description.....	58
Park Brake Lever Assembly	58
Park Brake Cables.....	58
Park Brake Cable Equalizer	58
Park Brake Apply Lever.....	58
Park Brake Actuator/Adjuster	58
Drum Brake Shoes	58
System Operation.....	58
ABS Description and Operation	58
Antilock Brake System	58
Engine Description and Operation.....	60
Engine Mechanical Specifications – 1.6L	60
General.....	60
Lubrication System.....	60
Cooling System	60
Fastener Tightening Specifications – 1.6L.....	60
Engine Component Description 1.6L	61
Cylinder Block	61
Crankshaft.....	62
Connecting Rod and Piston	62
Oil Pan.....	62
Cylinder Head.....	62
Valves.....	62
Camshaft.....	62

Camshaft Drive.....	62
Intake and Exhaust Manifold	62
Engine Lubrication – 1.6L	63
Engine Mechanical Specifications – 2.0L	64
General:.....	64
Lubrication System:.....	64
Cooling System:	64
Fastener Tightening Specifications – 2.0L.....	64
Engine Component Description – 2.0L	66
Engine Construction	66
Cylinder Block	66
Crankshaft	66
Connecting Rod and Piston	66
Oil Pump.....	66
Oil Pan.....	67
Cylinder Head.....	67
Valves.....	67
Valve Lifters.....	67
Valve Lifter (Hydraulic Valve Lash Adjuster) Operation.....	67
Camshaft	68
Camshaft Housings and Caps	68
Camshaft Drive.....	68
Timing Chain Housing and Cover	68
Cylinder Head Cover	68
Intake and Exhaust Manifold	68
Engine Lubrication – 2.0L	69
Engine Cooling	71
Engine Cooling System Approximate Capacities	71
Cooling System Capacity 1.6 L Engine.....	71
Cooling System Capacity 2.0 L Engine.....	71
Fastener Tightening Specifications.....	71
Cooling System Description and Operation.....	71
Coolant Heater – 2.0L Only.....	71
Cooling System	72
Cooling Cycle	72
Coolant	72
Radiator.....	72
Pressure Cap	72
Coolant Recovery System.....	73
Air Baffles and Seals	73
Water Pump	73
Thermostat	73
Engine Electrical.....	74
Fastener General Specifications.....	74
Fastener Tightening Specifications.....	75
Spark Plug Usage	75
Battery Description and Operation.....	76
Reserve Capacity.....	77
Cold Cranking Amperage.....	77
Circuit Description	77
Starting System Description and Operation.....	77
Charging System Description and Operation	78
Engine Controls	79
Engine Controls – 1.6L	79

Fastener Tightening Specifications	79
Engine Controls – 2.0L	80
Fastener Tightening Specifications	80
Fuel System Specifications – 1.6L and 2.0L	80
Exhaust System	82
Fastener Tightening Specifications	82
Exhaust System Description	82
Transmission/Transaxle Description and Operation	83
Manual Transmission Specifications	83
Fastener Tightening Specifications	83
Automatic Transmission - 4 Speed-M41	84
Fastener Tightening Specifications	84
Transmission General Information	84
Automatic Transmission Shift Lock Control Description	84
Clutch	85
Fastener Tightening Specifications	85
Clutch Operating Members	85
Hydraulic Clutch Description	85
Abbreviations and Meanings	i
Conversion - English/Metric	i
Equivalents - Decimal and Metric	iii
Fasteners	i
Metric Fasteners	i
Fastener Strength Identification	i
Prevailing Torque Fasteners	ii
All Metal Prevailing Torque Fasteners	ii
Nylon Interface Prevailing Torque Fasteners	ii
Adhesive Coated Fasteners	ii
Metric Prevailing Torque Fastener Minimum Torque Development	iii
All Metal Prevailing Torque Fasteners	iii
Nylon Interface Prevailing Torque Fasteners	iii
English Prevailing Torque Fastener Minimum Torque Development	iv
All Metal Prevailing Torque Fasteners	iv
Nylon Interface Prevailing Torque Fasteners	iv

Product Information

2000 Tracker — The Perfect Blend Of Refinement And Ruggedness

DETROIT — On the heels of an all-new 1999 year, the Chevy Tracker builds on its success as an agile and durable small utility. Tracker owners love their small utility vehicle because of its sporty looks, overall power, nimble handling and compact size.

Several new colors are added for 2000, including Dark Blue Metallic on Four-Door models, Bright Blue Metallic for Two-Door models, and Copper Brown Metallic available on both configurations.

"Many Tracker owners can afford larger SUVs, but buy a small SUV because it's the 'right' size for them," said Margaret Brooks, Tracker brand manager. "Many buyers believe Tracker is sized perfectly for zipping in and out of traffic and getting into tight parking spots."

While it was Tracker's new styling that helped contribute to a very successful launch last year, it was new features and smart engineering that considerably contributed to improving its agility and performance, SUV durability, and added room and comfort.

Rugged Exterior Styling

Some of the major styling changes* on the 1999 Tracker include:

- A lower roof line and sloping hood that contributes to a pleasing and sleek appearance
- All-new sheet metal with a more sculpted, muscular look
- A low-mounted spare that helped improve rearward driver visibility
- An easy-to-use two-piece convertible top on Two-Door models. Customers have the choice of opening and folding the rear section, flipping back the sunroof section or doing both. The top fits tightly and is designed to help reduce wind noise at highway speeds.

Nimble, Agile, Stand-and-Deliver Performance

While Tracker's styling changed dramatically, equally dramatic changes were made under the skin. Its rear suspension features a five-link design and greater tread width. The lateral locating link on the rear suspension helps improve how the handling feels. Tracker utilizes a power rack-and-pinion steering system that provides precise feel and responsiveness. Also changed was the front tread width which was increased by 2.4 inches, providing a wider stance for Tracker.

"Unlike some of the new unibody sport utilities, Tracker is built on a full ladder-type frame, just as every sport utility in the Chevy lineup," says Brooks. "A full frame helps Tracker achieve ride comfort by providing two levels of isolation. The suspension provides one level of isolation, and rubber body mounts between the body and frame provide a second level."

Tracker features a 2.0 liter 16-valve DOHC four-cylinder engine for 2000. The 2.0-liter engine is standard on Four-Door models and optional on the Two-Door Convertible. New for '99, this engine generated a 34-percent increase in horsepower than the previous generation Tracker.

SUV Durability and Strength

One of Tracker's greatest strengths is that it lives up to its sport utility heritage with outstanding durability, both on and off road. "Tracker is an authentic SUV, built to handle very rugged terrain," says Brooks. "That's important, because people choose sport utilities for their ruggedness and durability, even if they go off-roading only occasionally."

Tracker's sturdy ladder frame has the same basic design as other Chevrolet sport utility vehicles. The frame acts as a foundation that supports the body and the powertrain and anchors the suspension components.

Four-wheel-drive models featured an improved four-wheel-drive system for 1999. "Shift-on-the-fly" allows the driver to shift into and out of four-wheel-drive high at any speed below 60 mph, on demand. The two speed transfer case features 4-wheel-low, which helps Tracker out of tough spots, on or off road.

Tracker uses an anti-flex beam located under the hood that helps stiffen the front suspension and body structure (with 2.0-liter engine).

Wide Open Room and Comfort

Both Two- and Four-Door models have ample room, comfort and convenience. For instance, Tracker Four-Door models allow enough space for three passengers in the rear seat.

The adjustable tilt steering allows better articulation of the steering wheel than the previous generation's design and spacious storage areas have been incorporated throughout the vehicle. A few include:

- Sunglass holder in the instrument panel
- Seatback storage
- Convenient door pockets
- Center console featuring cup holders that are square instead of round, accommodating everything from cups to juice boxes to a box of french fries.
- Inside the Two-Door, the rear seat can be folded and stowed out of the way for more room.

The rear compartment on Two-Door models is passenger-friendly, with comfortable multi-use armrests and refined interior trim. An optional rear lockable storage compartment offers added security and is removable when maximum cargo space is needed.

"Chevy trucks offer the industry's widest range of sport utilities, which gives us an incredible marketing advantage," says Brooks. "We can tailor each product line to the specific needs of target buyers. When their needs change, and they start looking for more room or more engine power, we have a product they can move into."

In addition to Tracker, other Chevy sport utility vehicles include:

- Blazer
- Tahoe
- Suburban

* Claims and comparisons are made to the 1998 Tracker.

Brand Identity

What's New And Highlights

Exterior

New colors include:

- Dark Blue Metallic (Four-Door, 2WD and 4x4 models)
- Bright Blue Metallic (Two-Door models)
- Copper Brown Metallic (all models).

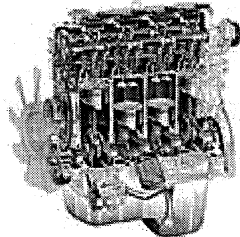

2.0-Liter DOHC Engine

An engine with moxie, the 2.0-liter DOHC engine provides Tracker with power for confident passing and acceleration.

Shift-On-The-Fly 4WD System

Provides all-weather traction plus enhanced convenience for owners of Tracker 4x4 models.

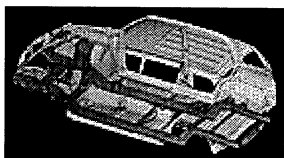
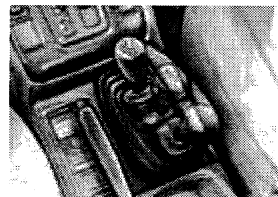

Full-Length Ladder-Type Frame

Tracker includes a sturdy full length ladder-type frame for predictable handling.

Marketplace

Tracker customers are self-confident, upbeat and down-to-earth individuals seeking a durable and agile small sport utility vehicle. They identify quality and trust with the Chevrolet name and want Tracker's versatility without buying a minivan.

Model Summary

- Tracker Two-Door Convertible, 2WD and 4x4
- Tracker Four-Door, 2WD and 4x4.

Competitors

Two-Door:

- Toyota RAV4 Soft Top
- Jeep Wrangler
- Suzuki Vitara Convertible
- Isuzu Amigo
- Kia Sportage Convertible.

Four-Door:

- Toyota RAV4
- Honda CR-V
- Kia Sportage
- Suzuki Vitara 4-Door
- Isuzu Amigo
- Subaru Forester.

Buyer Demographics

Two-Door

Median Age:	32.5 Years
Median Income:	\$40,000
Married:	50%
College Graduate:	42.5%
Purchaser:	Male 55% Female 45%
Children in Household:	27.5%

Four-Door

Median Age:	37.5
Median Income:	\$50,000
Married:	60%
College Graduate:	57.5%
Purchaser:	Male 45% Female 55%
Children in Household:	27.5%

Vehicle Overview

Interior Overview

Key Standard Features*

Tracker Two-Door Convertible Model:

- Driver and front-passenger air bags†
- Daytime Running Lamps (DRL) with Automatic Exterior Lamp Control
- Center console with multi-use cup holder and ashtray
- Driver and front-passenger doors with fabric inserts and storage pockets
- Front reading/map lights
- Auxiliary power outlet
- Delayed-entry lighting
- Passenger assist grips for front and rear passengers
- Rear-seat heat ducts
- Passenger-side visor vanity mirror
- Front bucket seats
- Flat-folding rear seat
- Front seatback storage pockets
- ETR AM/FM stereo with seek and digital clock
- Full carpeting, including the cargo area
- Easy-entry driver and front-passenger seats
- Variable intermittent windshield wipers
- Locking glove box.

Tracker Four-Door Model Adds The Following Equipment, In Addition To Or In Place Of Two-Door Convertible:

- Molded cloth headliner
- Front and rear carpeted floor mats
- Child security rear-door locks
- Split-folding rear seat
- Cargo area cover
- Cargo area net.

Key Optional Features*

- ETR AM/FM stereo with compact disc player, seek and digital clock.

* See Feature Availability Chart for additional features.

† Always use safety belts and proper child restraints, even with air bags. Children are safer when properly secured in a rear seat. See the owner's manual for more safety information.

Exterior/Structural Overview

Key Standard Features*

Tracker Two-Door Convertible Model:

- Hard plastic center-disc spare wheel cover
- Body-side molding
- Two-piece convertible top with sunroof and rear-folding top
- Outside-mounted full-size spare tire
- Center high-mounted stoplamp
- Tailgate opens to the side for easy cargo access
- Dual black rearview mirrors
- Power mirrors are included in the optional Convenience Package (4-Door models only)
- Fuel filler door incorporates a convenient holder for the fuel cap during refueling
- Optional luggage carrier, available on Four-Door models only
- Two-piece convertible top, available in Black, White and Tan (see Order Guide for convertible top/body color combinations)
- Rear-window wiper/washer is optional on Four-Door models and features a fixed delay
- Electric rear defogger is standard on all Four-Door models, not available on Two-Door models
- Standard front and rear recovery hooks (one each) provide convenient attachment points for off-road pulling situations
- Full ladder-type frame — the hallmark of Chevy SUVs. The frame features seven cross members for added reinforcement. This frame design resists twisting to help enhance durability and for a solid, stable ride on- and off-road. In addition, major components are protected within the confines of the frame
- Anti-flex bar, located in the engine compartment, is mounted between the front suspension towers. The bar increases the rigidity of the already tight body structure for a solid feeling. The anti-flex bar is standard on models equipped with the 2.0-liter engine.

Key Optional Features*

- Spare Tire Cover

Exterior Paint

Standard basecoat/clearcoat paint* on Tracker provides a high gloss shine for long-lasting exterior beauty. The clearcoat system is formulated to help reduce the effects of acid rain and other environmental damage. Other paint features include:

- Total immersion phosphate electrodeposition (ELPO) process applies the first layer of primer/paint. Electric voltage is applied to the bodies while they're submerged in the paint bath to ensure complete coverage, even in hard-to-reach areas.

Paint Colors

- Dark Blue Metallic (Four-Door models)
- Bright Blue Metallic (Two-Door models)
- Copper Brown Metallic (all models)
- Black
- Medium Green Metallic
- Sunset Red Metallic
- Wildfire Red Metallic
- Silver Metallic
- White.†

Convertible Top Colors:

- White
- Black
- Tan

* See Feature Availability Chart for additional features.

† White exterior does not include clearcoat process.

Functional Overview

Key Standard Features*

Tracker Two-Door Convertible Model:

- Stainless-steel exhaust system
- 1.6-liter, 16-valve, 4-cylinder SOHC engine with Multi-Port Fuel Injection
- 5-speed manual transmission with overdrive
- Power rack-and-pinion steering
- Front and rear recovery hooks (one each)
- Shift-on-the-fly four-wheel-drive system with two-speed transfer case (4x4 models only)
- Outside-mounted full-size lockable spare tire
- Tachometer, dual trip odometer and engine coolant temperature gauge
- 14.8 gallon fuel tank
- Battery-rundown protection
- P195/75R-15 all-season steel-belted radial tires with 15" styled steel wheels (2WD models only)
- P205/75R-15 all-season steel-belted radial tires with 15" styled steel wheels (4x4 models only).

* See Feature Availability Chart for additional features.

† Maintenance needs vary with different uses and driving conditions. See owner's manual for details.

Tracker Four-Door Model Adds The Following Equipment, In Addition To Or In Place Of Two-Door Convertible Models:

- Electric rear-window defogger with timed-delay shut-off
- 17.4 gallon fuel tank.

Key Optional Features*

- 4-wheel antilock brake system (ABS)

Optional Packages

Optional Accessory Packages Include:

- Off-Road Package includes brush/grille guard, light bar, 4x4 decal and a Tracker windshield decal (dealer-installed)
- BackPacker Package (Four-Door only) includes alloy wheel, luggage carrier, utility bar for luggage carrier, hard-shell rooftop carrier, hard spare tire cover and step package at the rear of the vehicle to facilitate access to the roof-mounted cargo carrier (dealer-installed).

Safety And Security*

Crash Avoidance Features

- Daytime Running Lamps (DRL)
- Automatic Exterior Lamp Control
- 4-wheel antilock brake system (optional)
- Clutch/starter interlock switch (standard with manual transmission)

- Brake/transmission shift interlock (included on Tracker models equipped with optional automatic transmissions).

Occupant Protection Features

- Driver and right front-passenger air bags†
- Front and rear outboard three-point safety belt
- Safety-cage construction
- Front and rear crush zones
- High strength steel side door beams
- Child security rear-door locks, (Four-Door models only)
- Cross-truck beam
- Energy-absorbing steering column.

Security Features

- Trunk lockable storage compartment, optional on Two-Door models
- Battery-rundown protection is standard on all Tracker models
- Remote Keyless Entry system, optional on Four-Door models within the Convenience Package (not available on Two-Door).

* For additional safety information, see the Chevrolet section of this Guide.

† Maintenance needs vary with different driving uses and driving conditions. See owner's manual for details.

** Always use safety belts and proper child restraints, even with air bags. Children are safer when properly secured in a rear seat. See the owner's manual for more safety information.

Sound Systems

Tracker Two-Door Convertible and Tracker Four-Door

Standard:

- ETR AM/FM stereo with seek, digital clock and four speakers

Optional:

- ETR AM/FM stereo with cassette player, seek, digital clock and auto tone control
- ETR AM/FM stereo with compact disc player, seek, digital clock and auto tone control

Seats

- Bucket seats with adjustable head restraints and seatback storage pockets are standard on all Tracker models
- Flat-folding rear seat is standard on Two-Door models and creates a flat load floor, making cargo easy to load. The seat is folded by moving the seat bottom forward, and then folding the seatback down into a scooped-out area of the floor
- True split-folding rear seat design is standard on Four-Door models. This seat folds flat for better loading capability than the previous design
- Three-across seating for rear passengers on Four-Door models.

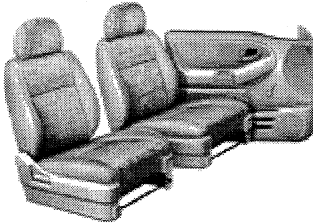

Tracker Two-Door:

Features Cityscape pattern cloth inserts and torrent bolsters with cloth facings and vinyl storage pockets.

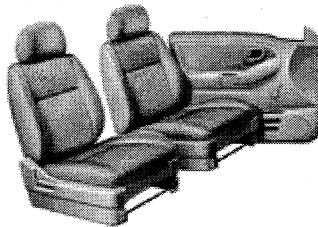

Tracker Four-Door:

Features Wicker pattern cloth inserts and torrent bolsters with cloth facings and vinyl storage pockets

Interior Colors

- Medium Warm Gray

Engineering

Tracker uses a sturdy full ladder-type frame with seven cross members for strength and rigidity which helps provide a smooth ride and crisp handling. Rocker panel moldings help protect the lower body from paint chips caused by flying debris that can lead to corrosion of bare metal.

Two peppy 16-valve engines with multi-port fuel injection provide Tracker's power, while two available transmissions ensure smooth shifts.

Tracker is manufactured by CAMI Automotive, Inc. in Ingersoll, Ontario, Canada — a joint venture between General Motors and Suzuki Motor Co., Ltd.

Engines

1.6-Liter SOHC 16-Valve L4 Engine (L01)

Two-Door models feature the standard 1.6-liter, single overhead camshaft, 16-valve, four-cylinder engine with Multi-Port Fuel Injection.

Power Ratings For The 1.6-Liter Engine:

- 97 horsepower at 5200 rpm
- 103 lb.-ft. of torque at 4000 rpm.

Technical Features Of This Engine:

- Aluminum cylinder head and cylinder block
- Direct ignition system
- Multi-Port Fuel Injection.

2.0-liter DOHC 16-Valve L4 Engine (L34)

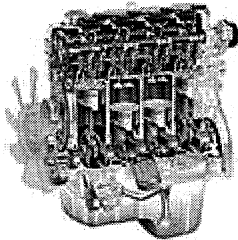

All 2000 Tracker Four-Door models feature the standard 2.0-liter, dual overhead camshaft, 16-valve, four-cylinder engine with Multi-Port Fuel Injection. This engine is also optional on Two-Door models.

Power Ratings For The 2.0-Liter Engine:

- 127 horsepower at 6000 rpm
- 134 lb.-ft. of torque at 3000 rpm.

Technical Features Of This Engine:

- Aluminum cylinder head and cylinder block
- Chain-driven camshaft
- Direct ignition system
- Multi-Port Fuel Injection.

Transmissions

Five-Speed Manual Transmission With 5th-Gear Overdrive

A five-speed manual transmission is standard on all Tracker models.

- Wide range of forward gear ratios (3.65:1 – 0.80:1)
- Fifth-gear overdrive reduces engine rpm at cruising speed, helping to increase fuel efficiency and reduce engine wear
- Axle ratios are matched for efficient operation. Two-Door models with the 1.6-liter engine feature a 5.12 axle ratio. Two- and Four-Door models with the 2.0-liter engine feature a 4.62 ratio with the five-speed manual transmission.

Four-Speed Automatic Transmission

A four-speed, electronically controlled automatic transmission is optional on Tracker models equipped with the 2.0-liter engine. Features of this transmission:

- Power/economy switch allows drivers to tailor performance to driving conditions by delaying upshifts when "power" mode is selected
- Axle ratios are matched for efficient operation. Two- and Four-Door models with the 2.0-liter engine feature a 4.87:1 axle ratio
- Long-life automatic transmission fluid has its first scheduled replacement at 100,000 miles under normal operating conditions*

* Maintenance needs vary with different uses and driving conditions. See owner's manual for more information.

Suspension

Front

Front suspension consists of independent MacPherson struts on both front wheels. The MacPherson struts use a coil spring separate from the shock absorber. This suspension system helps offer a stable ride, yet takes up minimal space. A front stabilizer bar is standard on all Tracker models. The stabilizer bar helps reduce the "leaning" feeling vehicles tend to exhibit when cornering.

Rear

Five-link design with a rigid "live" axle connected by upper and lower longitudinal arms, as well as a lateral locating link, is featured on the rear. This design provides a comfortable ride on-road, yet rugged dependability in off-road situations. Each side uses two trailing control arms to keep the axle in place, resisting forward and aft motions. Additionally, the lateral locating link, or panhard bar, is connected at one end to the axle, and at the other end to the frame. This component is used to counteract side-to-side forces placed on the axle.

Steering

- Both Two- and Four-Door Tracker models come standard with a rack-and-pinion system that helps provide precise feedback and good on-center feel.

Brakes

Power front disc/rear drum brakes are standard on all Tracker models. Both models feature vented front disc brakes to help improve fade-resistance under hard braking.

- 4-wheel antilock brakes are optional on all Tracker models. The antilock brake system (ABS) helps bring the vehicle to a controlled stop under a variety of road conditions. By controlling the amount of braking pressure to each wheel, ABS allows steering control to be maintained during hard braking situations.

Wheels And Tires

Wheels

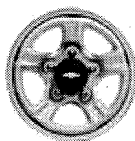

15-inch styled steel wheels standard on both Two- and Four-Door models.



15-inch alloy wheels optional on both Two- and Four-Door models. The spare tire is mounted on a steel wheel.

Tires

- P195/75R-15 all-season steel-belted radial tires are standard on 2WD Tracker models
- P205/75R-15 all-season steel-belted radial tires are standard on 4x4 models.

Feature Availability

	Two-Door Convertible 2WD/4x4	Four-Door 2WD/4x4
Interior		
Air bags - driver and front-passenger ¹	S	S
Air conditioning - with CFC-free refrigerant	O	O ²
Assist grips - 3 positions	S	S
Carpeting - full, including cargo area	S	S
Cargo area cover	NA	S
Center console - w/auxiliary power outlet, cup holders, storage tray and ashtray	S	S
Cruise control - with resume speed	O ³	O ³
Defogger - rear-window electric	NA	S
Delayed entry lighting	S	S
Door locks - power	NA	O ⁴
Floor mats - carpeted front and rear	S	S
Rear seat heat ducts	S	S
Seats - rear, fold and stow	S	NA
- rear, split folding	NA	S
- easy-entry front	S	NA
Seat trim - cloth facings with vinyl seatbacks	S	S
Stereo - ETR AM/FM stereo with seek and digital clock	S	S
- ETR AM/FM stereo with cassette player seek and digital clock	O	O
- ETR AM/FM stereo with compact disc, seek, digital clock	O	O
Tilt steering wheel	O ³	O ³
Windows - power	NA	O ³
Windshield wipers - variable intermittent	S	S
Exterior		
Daytime Running Lamps with Automatic Exterior Lamp Control	S	S
Bumpers - front and rear, dark charcoal	S	S
Luggage carrier	NA	O
Mirrors - dual outside, black, manual	S	S
- dual outside, black, power	NA	O ³
Moldings - body-side, dark charcoal	S	S
Spare tire cover - black vinyl with Tracker lettering	O	O
Rear window wiper/washer	NA	O ³
Tailgate - swing-open right-hand hinged door w/lock	S	S
Tires - P195/75R-15 all-season radial	S/NA	S/NA
- P205/75R-15 all-season radial	NA/S	NA/S
Recovery Hooks - front and rear (one each)	S	S
Wheels - 15-inch styled steel with black bowtie center cap	S	S
- 15-inch alloy with black bowtie center cap	O	O
Functional		
Brakes - 4-wheel antilock	O	O
- front disc, rear drum	S	S
Engine - 1.6 liter SOHC 16 valve L4 multi-port fuel injection	S ⁵	NA
Engine - 2.0 liter DOHC 16 valve L4 multi-port fuel injection	O	S
Hubs - front automatic locking	NA/S	NA/S
Skid plate - fuel tank	S	S

2000 Chevrolet Tracker Restoration Kit

Stainless steel exhaust	S	S
Steering - power, rack-and-pinion	S	S
Suspension- MacPherson strut with separate coil springs and lower"A" arm, front	S	S
- 5-link with upper and lower longitudinal trailing arms and lateral control arm, rear	S	S
Transfer Case - 2-speed shift on the fly	NA/S	NA/S
Transmission - 5-speed manual	S	S
- 4-speed automatic	O ⁶	O

S - Standard.

O - Optional (some options may be available only as part of a Preferred Equipment Group).

NA - Not available.

1 Always use safety belts and proper child restraints, even with air bags. Children are safer when properly secured in a rear seat.

See the owner's manual for more safety information.

2 Includes replaceable pollen filter.

3 Requires Preferred Equipment Group (1SB).

4 Requires Convenience Package.

5 Manual transmission only.

6 Requires 2.0L engine.

Specifications

Model Availability

Chevy Tracker 2-Door Convertible and Tracker 4-Door	
EPA vehicle class	Special Purpose Vehicle
Assembly plant	CAMI, Ingersoll, Ontario

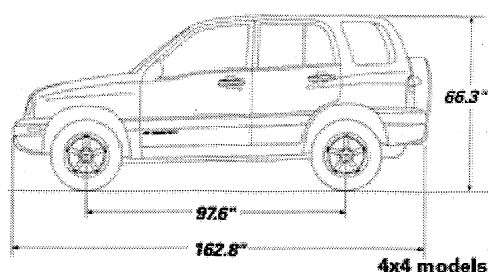
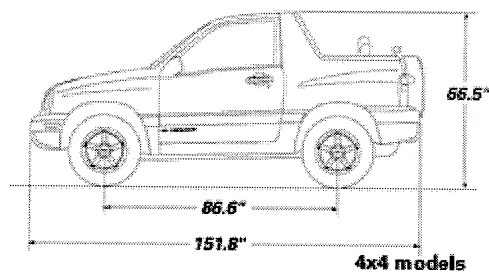

Specifications & Capacities

	2-Door 2WD; 4x4	4-Door 2WD; 4x4
Exterior Dimensions		
Wheelbase	86.6/2200	97.6/2480
Overall length	151.6/3851; 151.8/3855	162.6/4130; 162.8/4135
Width Overall	67.3/1710	67.3/1710
Overall height	66.5/1690	65.6/1667; 66.3/1684
Tread - front	57.5/1460	57.5/1460
Tread - rear	57.5/1460	57.5/1460
Minimum running ground clearance (4x4)	8.0/202	8.0/202
Interior Front Dimensions		
Headroom	40.9/1038	39.9/1013
Legroom	41.4/1051	41.4/1051
Shoulder room	53.0/1345	52.8/1341
Hip room	50.6/1290	50.7/1287
Interior Rear Dimensions		
Headroom	39.5/1003	39.6/1006
Legroom	35.9/912	35.9/912
Shoulder room	52.6/1336	52.6/1336
Hip room	46.8/1188	46.8/1188
Capacities		
Passenger capacity	4	5
Passenger index (cu. ft./liters approx.)	90.5/2562	90.3/2557
Cargo index (cu. ft./liters)	6.3/178.4	13.4/379.4
Fuel tank capacity (gal./liters, approximate)	14.8/56.0	17.4/66
EPA interior index (cu. ft./liters)	96.8/2741.0	103.7/2936.4
Base curb weight (lbs./kg, 2WD)	2602/1181	2866/1300
Base curb weight (lbs./kg, 4WD)	2723/1235	2987/1355
Cargo volume (cu. ft./liters)	10.2/290	20.2/572
Cargo volume (cu. ft./liters with rear seat down)	33.7/954	44.7/1266

Steering		
Type	Power rack-and-pinion	
Ratio (overall)	20.5:1	
Turns stop-to-stop	3.8	
Turning diameter curb-to-curb (ft./m)	31.5-34.8/9.6-10.6 (2-Door - 4-Door)	
Turning diameter wall-to-wall (ft./m)	32.5 - 35.8/9.9 - 10.9 (2-Door - 4-Door)	
Brakes		
Models	Two-Door and Four-Door	
Type	Power vented front disc/rear drum (4-wheel ABS opt.)	
Front disc rotor outer working diam. (in.)	11.3	
Rear drum diameter x width (in.)	8.7 x 2.1	
Total swept area, front/rear (sq. in.)	184.9/85.7	
Engines		
Type	1.6 Liter, 16-valve, SOHC L4	2.0 Liter, 16-valve, DOHC L4
Block material	Aluminum alloy	Aluminum alloy
Cylinder head material	Aluminum alloy	Aluminum alloy
Hydraulic lifters	NA	Standard
Bore & stroke (in./mm)	2.95 x 3.54/75.0 x 90.0	3.31 x 3.54/84.0 x 90.0
Cam drive	Belt	Chain
Displacement (cu. in./cc)	1.6/97	2.0/121
Compression ratio	9.5:1	9.7:1
Fuel induction	MPFI	MPFI
Horsepower/kW @ RPM(SAE net)	97 @ 5200/72 kW @ 5200	127 @ 6000/95 kW @ 6000
Torque/N-m (lb.-ft.) @ engine RPM	103 @ 4000/140 N-m @ 4000	134 @ 3000/182 N-m @ 3000
Exhaust system	Single	Single
Tailpipe(s)	Stainless steel	Stainless steel
Ignition system	Direct ignition	Direct ignition with one coil per cylinder
Alternator rating (amps)	60	70
Battery (SAE capacity rating, cca)	390	550
Recommend fuel (unleaded)	87 octane	87 octane
Transmissions		
	Standard	Optional
Transmission	5-speed manual	4-speed automatic electronically controlled
Layout	RWD longitudinal	RWD longitudinal
Gear ratios:		
1st	3.65	2.83
2nd	1.95	1.49
3rd	1.38	1.00
4th	1.00	0.69
5th	0.80	-
Reverse	3.67	2.70
Final-drive ratios	5.12*	4.87

* 4.62 with 2.0L engine. NA - Information not available at time of publication.

Chassis			
Chassis			
Structure/frame	Body with separate ladder-type frame		
Body material	Steel		
Suspension - front			
Type	MacPherson strut with separate coil spring, double-action telescoping shock absorbers		
Stabilizer bar/type (mm)	Link/22 mm - 24 mm (2-Door - 4-Door)		
Suspension - rear			
Type	Rigid axle with 5-link design - upper and lower trailing arms,Panhard bar and double-action telescoping shock absorbers		
Mileage/Performance*			
Engine	1.6 Liter L4	2.0 Liter L4	2.0 Liter L4
Transmission	5-speed manual	5-speed manual	4-speed automatic
Mileage:			
Two-Door 2WD			
City	25	23	23
Highway	28	25	25
Est. Cruising Range:			
City	370	340	340
Highway	414	370	370
Two-Door 2WD			
City	25	22	23
Highway	27	25	25
Est. Cruising Range:			
City	370	325	340
Highway	399	370	370
Four-Door 2WD			
City	-	23	24
Highway	-	25	26
Est. Cruising Range:			
City	-	400	417
Highway	-	435	452
Four-Door 4WD			
City	-	22	23
Highway	-	25	25
Est. Cruising Range:			
City	-	382	400
Highway	-	435	435

* 1999 EPA estimates.

Trailer Information		
	Two-Door	Four-Door
Trailer classification	Light	Light
Gross trailer weight (lbs/kg., up to)	1000/454*	1500/680*

* When properly equipped for trailering. Trailer ratings are calculated assuming the tow vehicle has all the required trailering equipment. The weight of the passengers, additional optional equipment or cargo may reduce trailer ratings. Trailer tongue weight should be 10 to 15 percent of total loaded trailer weight. Addition of trailer tongue weight cannot cause weights to exceed Rear Gross Axle Weight Rating (RGAWR) or Gross Vehicle Weight Rating (GVWR) - these ratings can be found on the certification label located on the driver-side front door or door frame. NOTE: refer to vehicle owner's manual for additional towing information and advice before towing with your Chevy Tracker.

Wheels & Tires	
Wheel type/size	Steel/15" x 5.5"
Tire type	all-season steel-belted radial
Tire size	P195/75R-15 (2WD) P205/75R-15 (4x4)
Spare size	Full-size spare mounted on steel wheel

All specifications are preliminary and subject to change. Chevrolet Motor Division, June 1999.

Vehicle Identification

Vehicle Identification Number (VIN)

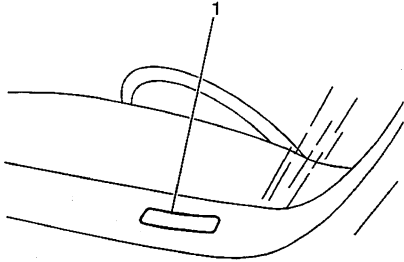

The vehicle identification number (VIN) plate is the legal identifier of the vehicle. The VIN plate is located on the upper LH corner of the Instrument Panel and can be seen through the windshield from the outside of the vehicle:

Position	Definition	Character	Description
1	Country of Origin	2	Canadian Built
2	Manufacturer	C	CAMI
3	Make	N	Chevrolet MPV
4	GVWR/Brake System	B	3001-4000
5	Truck Line/Chassis Type	E	Compact Cab 4X2
6	Series	J	Compact Cab 4X4
7	Body Type	1	½ Ton
8	Engine Type	8	Two Door Utility
9	Check Digit	3	Four Door Cab/Utility
10	Model Year	6	1.6L, L4, MFI
11	Plant Location	C	2.0L, L4, MFI
12-17	Plant Sequence Number	--	Check Digit
		Y	2000
		6	Ingersoll, Ontario
		--	Production Plant Sequence Number

VIN Derivative

All engines and transmissions are stamped or laser etched with a partial vehicle identification number (VIN), which was derived from the complete VIN. A VIN derivative contains the following nine positions:

Position	Definition	Character	Description
1	GM Division Identifier	N	Chevrolet
2	Model Year	Y	2000
3	Assembly Plant	6	Ingersoll, Ontario
4-9	Plant Sequence Number	--	--

A VIN derivative can be used to determine if a vehicle contains the original engine or transmission, by matching the VIN derivative positions to their accompanying positions in the complete VIN:

VIN Derivative Position	Equivalent VIN Position
1	3
2	10
3	11
4-5	12-17

Label - Vehicle Certification

The vehicle certification label is permanently located on the drivers door lock pillar. Refer to this label in order to obtain the following information:

- The Gross Vehicle Weight Rating (GVWR)
- The Gross Axle Weight Rating (GAWR), front and rear

The Gross Vehicle Weight (GVW) must not exceed the Gross Vehicle Weight Rating (GVWR).

The GVW is the weight of the vehicle and everything the vehicle carries. Include the following items when figuring the GVW:

- The base vehicle weight (factory weight)
- The weight of any added vehicle accessories
- The weight of the driver and the passenger
- The weight of any cargo being carried

The front and rear Gross Axle Weights (GAW) must not exceed the Gross Axle Weight Ratings (GAWR), front and rear.

The GAW is the weight exerted on one of the axles (front or rear).

Tire Placard

	FRONT	REAR
T I R E S	P195/75R15	P195/75R15
R I M S	15X5 1/2JJ	15X5 1/2JJ
INFLATION PRESSURE COLD kPa/PSI	180/26	180/26

67D10

The tire placard is located on the left door lock pillar. Refer to the placard to obtain:

- The maximum vehicle capacity weight
- The cold tire inflation pressures
- The tire sizes (original equipment tires)
- The tire speed ratings (original equipment tires)

Service Parts Identification Label (SPID)

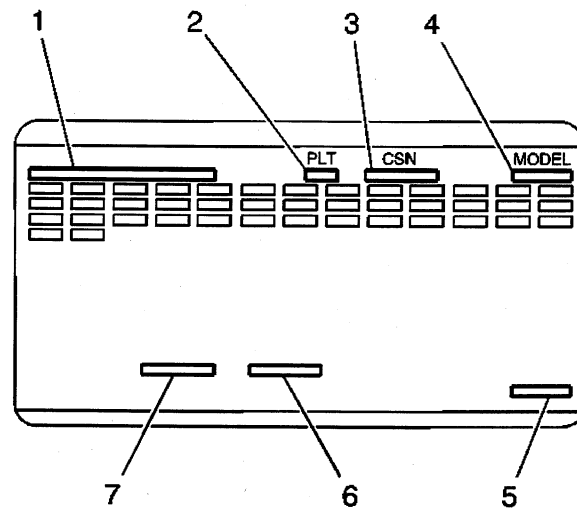

- (1) Vehicle Identification Number
- (2) Assembly Plant
- (3) Build Sequence
- (4) Model Designation
- (5) Paint Technology
- (6) Paint Type
- (7) Exterior Paint Number

SPID Label Location

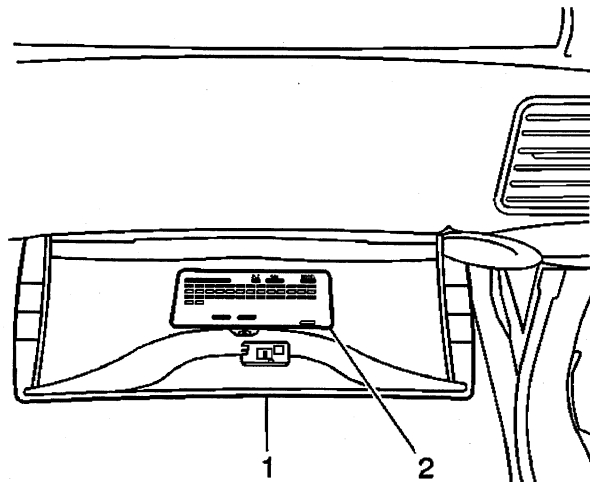

The service parts identification label (2) is placed on the vehicle in order to help service and parts personnel identify the vehicle's original parts and the vehicle's original options. The label (2) is located on the inside of the IP compartment (1).

Engine ID and VIN Derivative Location 1.6L

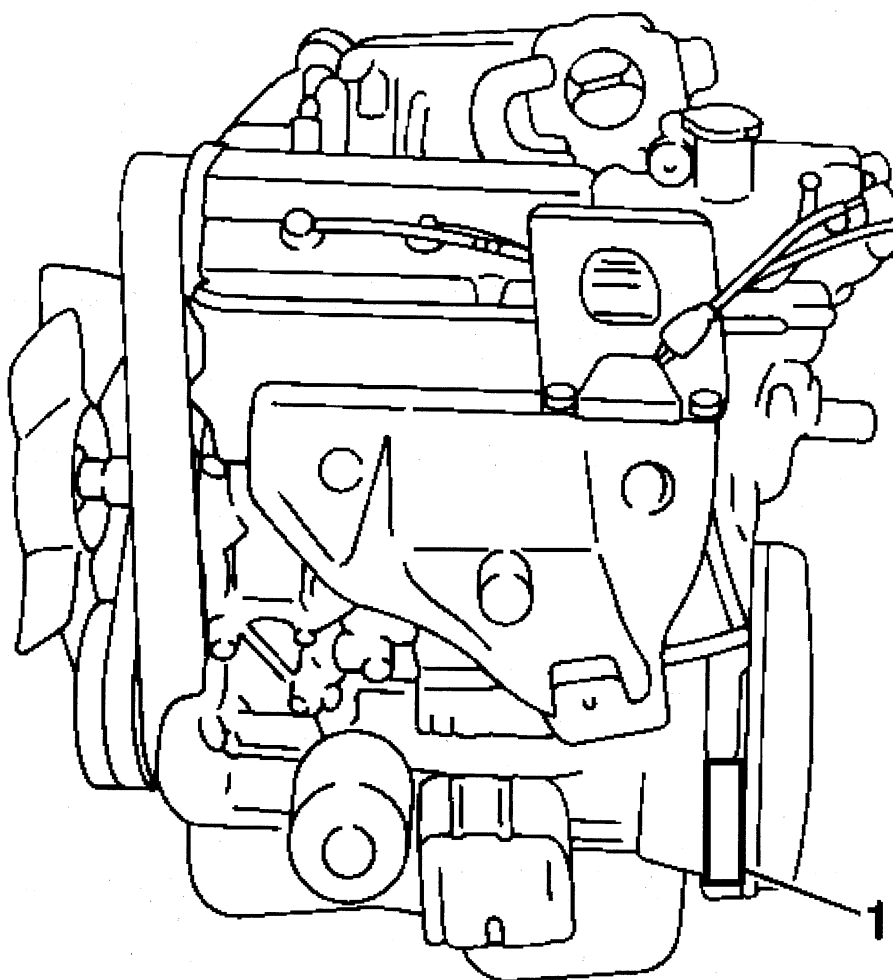

The engine code letter is the eight digit of the VIN, which identifies the engine.

Stick-on labels attached to the engine, laser etching, or stampings in the engine block indicate the engine type, the engine displacement, the model year and the production sequence number.

The engine ID number is located on the lower left engine block area at the bellhousing.

Engine ID and VIN Derivative Location 2.0L

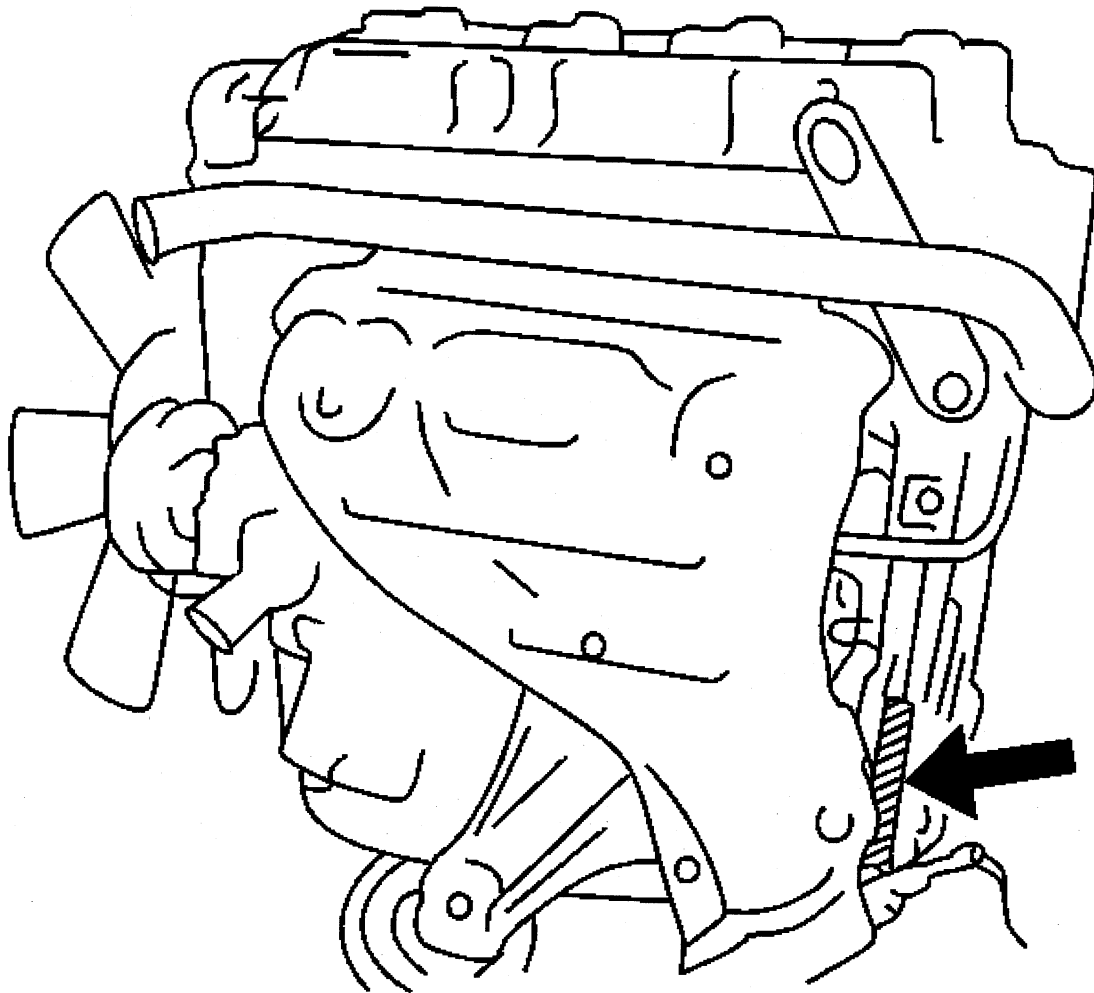

The engine code letter is the eight digit of the VIN, which identifies the engine.

Stick-on labels attached to the engine, laser etching, or stampings in the engine block indicate the engine type, the engine displacement, the model year and the production sequence number.

The engine ID number is located on the lower left engine block area at the bellhousing (1).

Transmission ID and VIN Derivative Location

Manual Transmission

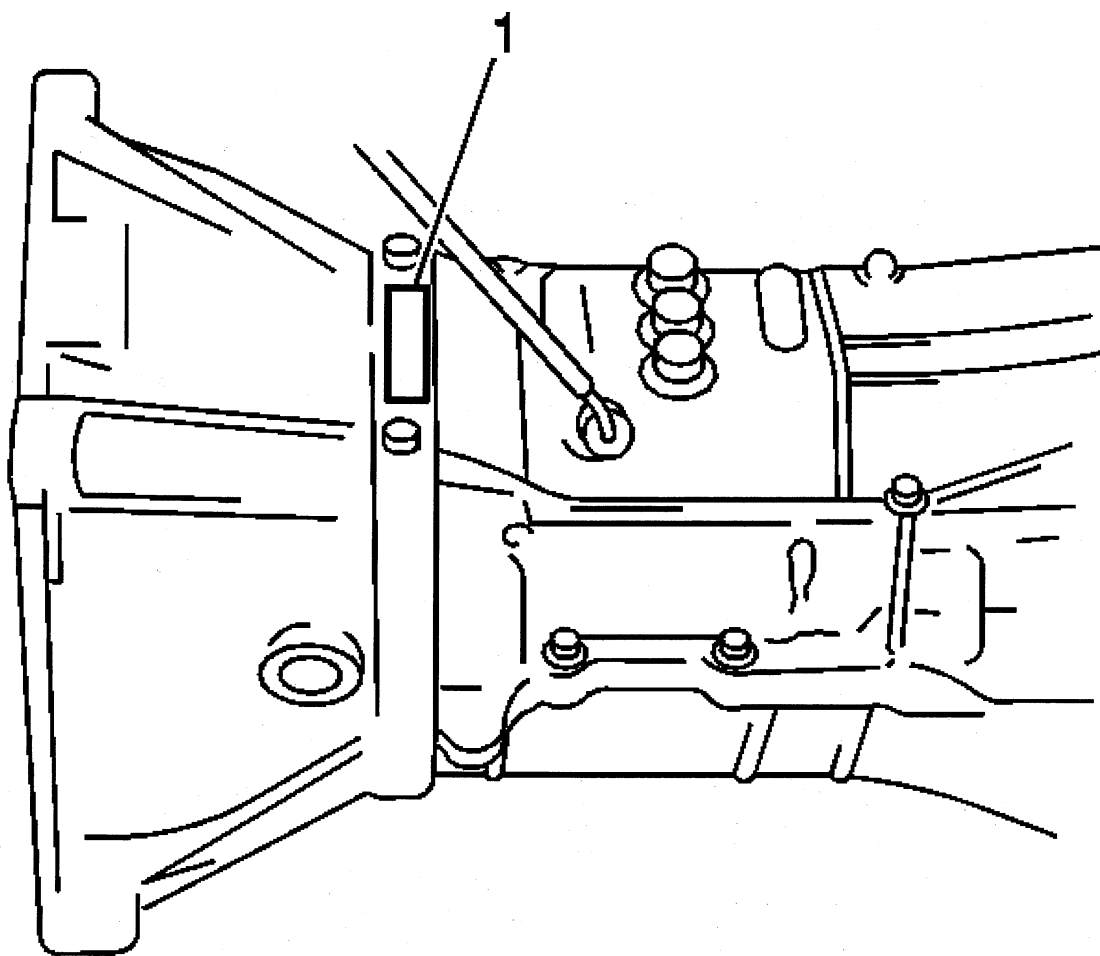

The manual transmission model identification is located on a label or tag or stamped or etched on the transmission case (1). If this label is missing or unreadable, use the service parts identification label in order to identify the vehicle's transmission.

Automatic Transmission

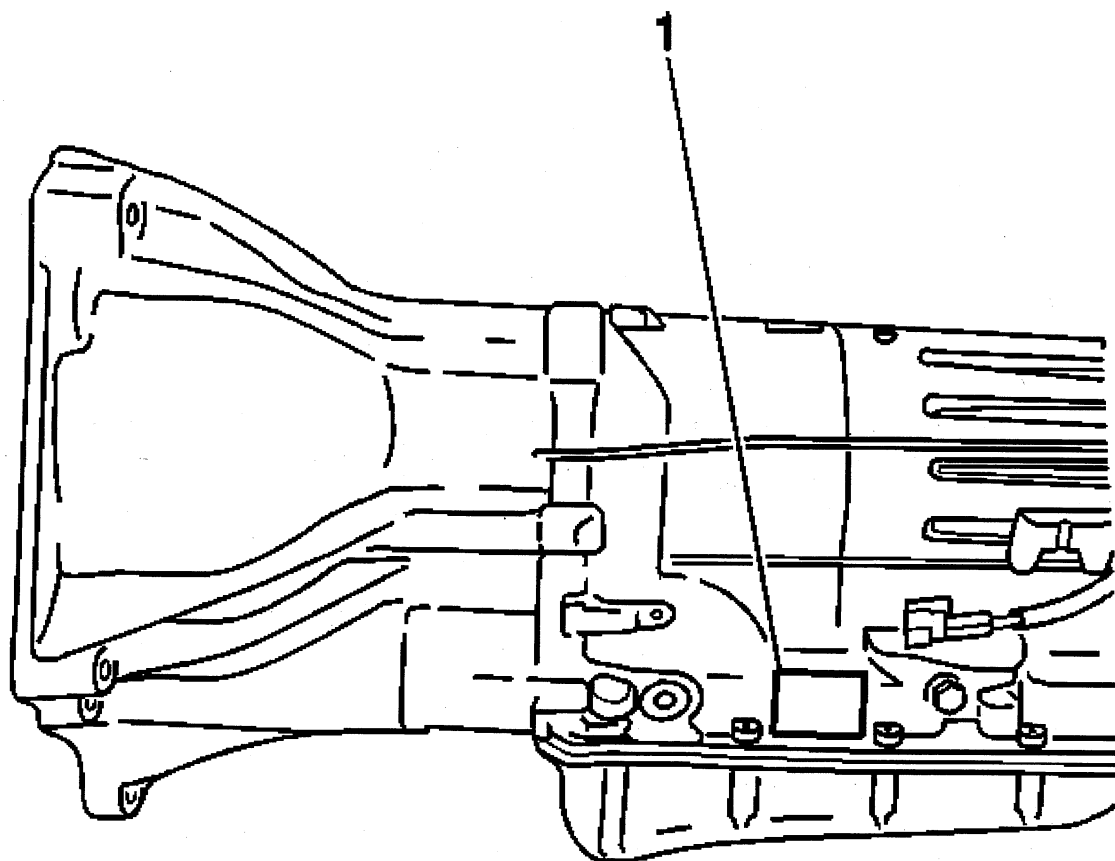

The automatic transmission model identification is located on a label or tag or stamped or etched on the transmission case (1). If this label is missing or unreadable, use the service parts identification label in order to identify the vehicle's transmission.

Engine and Transmission Usage

Body Type	Car Line (Division)	Engine Size	Fuel System	Engine RPO	Transmission Used	Transmission RPO
E/J	Tracker	1.6L	MFI	LO1	5 Speed Manual Only	M59
E/J	Tracker	2.0L	MFI	L34	4 Speed Auto/5 Speed Manual	M41/M59

Labeling - Anti-Theft

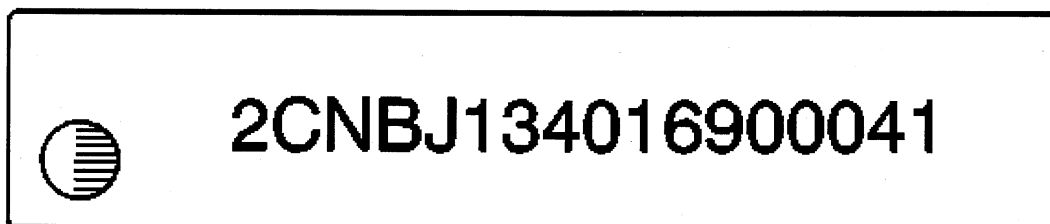

Federal law requires General Motors (GM) to affix a label to certain parts on selected vehicles with the Vehicle Identification Number (VIN). The purpose of this law is to reduce the number of motor vehicle thefts by helping in the tracing and recovery of parts from stolen vehicles. The certification label on the driver's door qualifies as a theft deterrent label.

The theft deterrent label will be permanently affixed to an interior surface of the part and will contain the complete VIN. The label on replacement parts will contain the letter R, the manufacturer's logo, and the acronym for the Department of Transportation (DOT). DO NOT deface, or remove these labels.

RPO Code List

The production/process codes provide the description of the Regular Production Options (RPOs) used on the vehicle. The RPO list is printed on the Service Parts Identification Label. The following is a list of the RPO abbreviations and the description of each:

RPO	Description
AK5	Restraint System Front Seat, Inflatable, Driver and Passenger
AK6	Restraint System Seat, Inflatable, Driver and Passenger, Delete
AM7	Seat Rear Folding
AM9	Seat Rear Split Back, Folding
AN4	Restraint Provisions Child
ARZ	Net Removable Stowage Bag
AR9	Seat Front Bucket, Deluxe
AUO	Lock Control, Entry Remote Entry
AU3	Lock Control Side Door, Electric
A31	Window Power Operated, Side
BNN	Compartment Stowage, Cargo Area
B37	Covering Floor Mat, Front & Rear, Aux
B58	Covering Floor Mat, Front & Rear, Carpeted Insert
B84	Molding Body Side Exterior
C25	Wiper System Rear Window
C42	HVAC System Heater Deluxe Outside Air
C49	Defogger Rear Window, Electric
C60	HVAC System Air Conditioner Front Manual Controls
DG7	Mirror Outside Left Hand and Right Hand, Remote Control, Electric, Color
DL5	Decal Roadside Service Information
DR1	Mirror Outside Left Hand and Right Hand, Manual Control, Color
D42	Shade Rear Compartment
D88	Decal Stripe, Sport
FE9	Certification Emission, Federal
HC1	Axle Rear 4.62 Ratio
HC3	Axle Rear 5.12 Ratio
HC8	Axle Rear 4.87 Ratio
JM4	Brake System Power, Front Disc, Rear Drum, Cast Iron, Antilock, Front and Rear Wheel
J41	Brake System Power, Front Disc, Rear Drum, Cast Iron
K34	Cruise Control Automatic, Electronic
LO1	Engine Gas, 4 Cylinder, 1.6L, MFI, OHC
L34	Engine Gas, 4 Cylinder, 2.0L, MFI, DOHC
MM5	Merchandised Transmission Manual 5 Speed Provisions
MX0	Merchandised Transmission Automatic Provisions, O/D
M41	Transmission Auto 4 Speed, 2.828 1st, 0.730 4th
M59	Transmission Manual 5 Speed, Suzuki, 3.65 1st, 0.795 5th
NC1	Emission System California, Lev
NF2	Emission System Federal, Tier 1
NF7	Emission System Federal, NLEV
NG1	Certification Emission, Geographically Restricted Registration
N33	Steering Column Tilt Type
N40	Steering Power, Non-Variable Ratio
PG2	Wheel 15 X 5.5, Steel
P17	Spare Wheel Cover
QAR	Tire All P195/75R15-94S BW R/PE ST TL ALS 94S
QA4	Wheel 15 X 5.5 Aluminum

2000 Chevrolet Tracker Restoration Kit

QCE	Tire All P205/75R15/N BL R/PE ST TL ALS
T61	Lamp System, Daytime Running
T62	Lamp System, Daytime Running - Delete
T82	Headlamps Control Automatic On-Off
UH8	Cluster Instrument, Cool Temperature, Trip Odometer, Tach
UL5	Radio Delete
UM6	Radio AM/FM Stereo, Seek/Scan, Auto Reverse Cassette, Clock, ETR
UM7	Radio AM/FM Stereo, Seek/Scan, Clock, ETR
UQO	Speaker System 4, Dual Front Door Mounted, Dual Standard Range Quarter/Shelf
U1C	Radio AM/FM Stereo, Seek/Scan, Compact Disc, Clock, ETR
U73	Antenna Fixed, Radio
VB1	Label Shipping, Japan
VC5	Label Shipping, Except US, US Possessions, or Japan
VD9	Fascia Front & Rear, Body Color
VG8	Vehicle Label, Notice to Buyer
V54	Luggage Carrier Roof, Painted
V73	Vehicle Statement USA/Canada
WR0	Appearance Package Special Edition Tracker
XR5	Filter Pollen
X88	Conversion Name Plate Chevrolet
YF5	Certification Emission, California
ZY1	Color Combination Solid
Z05	Convenience Package
Z49	Export Canadian Modif Mandatory Base Equip
10T	Top Color Artic White (96)
16U	Primary Color Exterior, Brite White (96)
17D	Trim Combination Cloth, Medium Gray (97) (D)
17E	Trim Combination Cloth, Medium Gray (97) (E)
17I	Interior Trim Medium Gray (I) (97)
17U	Primary Color Exterior, Silvermist Metallic (97)
19U	Primary Color Exterior, Lamp Black (96)
29U	Primary Color Exterior, Blue Green Metallic (98)
35U	Primary Color Exterior, Green Metallic (00)
41T	Top Color Black (96)
47U	Primary Color Exterior, Dark Blue Metallic (96)
53U	Primary Color Exterior, Light Toreador Red Metallic (97)
61T	Top Color Tan (96)
65U	Primary Color Exterior, Copper Bronze (94)
74U	Primary Color Exterior, Victory Red (96)
89U	Primary Color Exterior, Dark Mulberry Metallic (97)

Technical Information

Maintenance and Lubrication

Drive Belt Tension Specifications

Application	Specification	
	Metric	English
A/C Compressor	6-9 mm at 10 kg	0.24-0.35 in at 22 lbs
Coolant Pump (2.0 L)		
• New Belt (under 5 minutes of use)	4-5 mm at 10 kg	0.16-0.19 in at 22 lbs
• Used Belt	5-7 mm at 10 kg	0.20-0.27 in at 22 lbs
Coolant Pump/Generator (1.6 L)		
• New Belt (under 5 minutes of use)	5-7 mm at 10 kg	0.20-0.27 in at 22 lbs
• Used Belt	6-8 mm at 10 kg	0.24-0.32 in at 22 lbs
Power Steering Pump	6-9 mm at 10 kg	0.24-0.35 in at 22 lbs

Capacities - Approximate Fluid

Application	Specification	
	Metric	English
4-Speed Automatic Transmission (RPO M41)		
• Bottom Pan Removal	2.5 liters	2.6 quarts
• Complete Overhaul (1.6 L)	6.9 liters	7.3 quarts
• Complete Overhaul (2.0 L)	7.1 liters	7.5 quarts
5-Speed Manual Transmission (RPO M59)		
• Two-Wheel-Drive Models	1.9 liters	2.0 quarts
• Four-Wheel-Drive Models	1.5 liters	1.6 quarts
• Transfer Case (Four-Wheel-Drive Only)	1.7 liters	1.8 quarts
Axle Housing		
• Front	1.0 liters	1.1 quarts
• Rear	2.2 liters	2.3 quarts
Cooling System Capacity		
• 1.6L Engine	5.5 liters	5.8 quarts
• 2.0L Engine	6.5 liters	6.9 quarts
Engine Crankcase		
• Without Filter Change 1.6L Engine	4.0 liters	4.2 quarts
• Without Filter Change 2.0L Engine	5.0 liters	5.3 quarts
• With Filter Change 1.6L Engine	4.2 liters	4.4 quarts
• With Filter Change 2.0L Engine	5.2 liters	5.5 quarts
Fuel Tank		
• 2-Door Models	56.0 liters	14.8 gallons
• 4-Door Models	66.0 liters	17.4 gallons

Maintenance Items

Application	Specification
A/C Evaporator Air Filter (4 door only)	GM P/N 91175057
Air Cleaner Element	GM P/N 91174457
Fuel Filter	GM P/N 30020673
Oil Filter	
• 1.6 Liter Engine, AC Type PF53	GM P/N 25011520
• 2.0 Liter Engine	GM P/N 91173772
Positive Crankcase Ventilation (PCV) Valve	
• 1.6 Liter Engine	GM P/N 96068664
• 2.0 Liter Engine	GM P/N 91174516
Spark Plugs	
• 1.6 Liter Engine, NGK BKR6E-11	GM P/N 91173854
• 1.6 Liter Engine, Denso K20PR-U11	GM P/N 91173855
• 2.0 Liter Engine, NGK IFR5G11	GM P/N 91175704
• 2.0 Liter Engine, NGK PFR5G-11	GM P/N 91175705
• 2.0 Liter Engine, Denso SK16PR11	GM P/N 91175706
• 2.0 Liter Engine, Denso PK16PR11	GM P/N 91175707

Tire Inflation Pressure Specifications

Tire Size	Specification	
	kPa	psi
P195/75R15 (Front)	180	26
P195/75R15 (Rear)	180	26
P205/75R15 (Front)	180	26
P205/75R15 (Rear)	180	26
Spare	180	26

Fluid and Lubricant Recommendations

Application	Fluid/Lubricant
Automatic Transmission	DEXRON®-III Automatic Transmission Fluid GM P/N 12346143 (Canadian P/N 10952622) or the equivalent
Chassis Lubrication	Chassis Lubricant GM P/N 12377985, a lubricant meeting the requirements of NLGI # 2, Category LB or GC-LB, or the equivalent
Clutch Linkage Pivot Points	Chassis Lubricant GM P/N 12377985, a lubricant meeting the requirements of NLGI # 2, Category LB or GC-LB, or the equivalent
Engine Coolant	A 50/50 mixture of clean water (preferably distilled) and a good quality Ethylene Glycol Base Coolant GM P/N 1052753 (Canadian P/N 993089) or an equivalent conforming to GM Specification 1825M or an approved recycled coolant conforming to GM Specification 1825M.
Engine Oil	The engine oil with the American Petroleum Institute Certified For Gasoline Engines "Starburst" symbol of the proper viscosity.
Floor Shift Linkage	Lubriplate® Lubricant Aerosol GM P/N 12346293, a lubricant meeting the requirements of NLGI # 2, Category LB or GC-LB, or the equivalent
Front Wheel Bearings	Wheel Bearing Lubricant meeting the requirements of NLGI # 2, Category GC or GC-LB GM P/N 1051344 (Canadian P/N 993037) or the equivalent
Hood and Door Hinges	Multi-Purpose Lubricant, Superlube® GM P/N 12346241 (Canadian P/N 10953474) or the equivalent
Hood Latch Assembly, Secondary Latch Assembly, Pivots, Spring Anchor and Release Pawl	Lubriplate® Lubricant Aerosol GM P/N 12346293, a lubricant meeting the requirements of NLGI # 2, Category LB or GC-LB, or the equivalent
Hydraulic Brake System	Delco Supreme 11® Brake Fluid GM P/N 12377967 (Canadian P/N 992667) or an equivalent DOT-3 brake fluid
Hydraulic Clutch System	Hydraulic Clutch Fluid GM P/N 12345347 (Canadian P/N 10953517) or the equivalent
Key Lock Cylinders	Multi-Purpose Lubricant, Superlube® GM P/N 12346241 (Canadian P/N 10953474) or the equivalent
Manual Transmission Shift Linkage	Chassis Lubricant GM P/N 12377985, a lubricant meeting the requirements of NLGI # 2, Category LB or GC-LB, or the equivalent
Manual Transmission-All and Transfer Case-Four-Wheel-Drive	GM Goodwrench Synthetic Manual Transmission Fluid GM P/N 12346190 (Canadian P/N 10953477) or an equivalent SAE 75W-90 GL-4 Gear Oil
Parking Brake Cable Guides	Chassis Lubricant GM P/N 12377985, or lubricant meeting the requirements of NLGI # 2, Category LB or GC-LB
Power Steering System	DEXRON®-III Automatic Transmission Fluid GM P/N 12346143 (Canadian P/N 10952622) or the equivalent
Rear Axle-All and Front Axle-Four-Wheel Drive	Axle Lubricant GM P/N 12345977 (Canadian P/N 10953482) or SAE 80W-90 GL-5 Gear Lubricant
Weatherstrip Conditioning	Dielectric Silicone Grease GM P/N 12345579 (Canadian P/N 1974984) Weatherstrip Lubricant-Krytox GM P/N 3634770, or the equivalent
Windshield Washer Solvent	GM Optikleen® Washer Solvent GM P/N 1051515 (Canadian P/N 993033) or the equivalent

Descriptions and Operations

Power Steering System Description and Operation

Power Steering Gear Description

The steering gear includes the steering gear boots and the inner tie rods. DO NOT disassemble the steering gear.

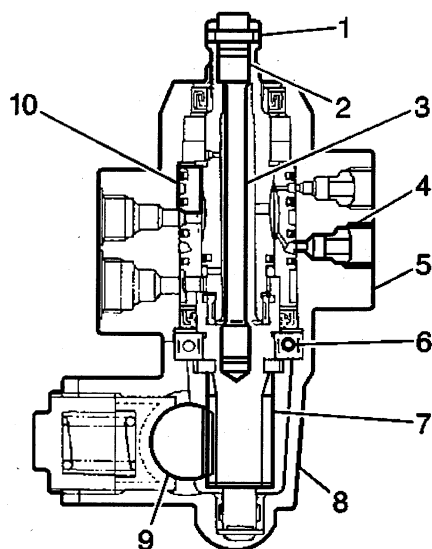

- (1) Pin
- (2) Stub Shaft
- (3) Torsion Bar
- (4) Ferrule
- (5) Valve Case
- (6) Bearing
- (7) Pinion
- (8) Steering Gear Housing
- (9) Rack
- (10) Sleeve

The steering gear consists of a cylinder section and a valve section. The main components of the cylinder section are the gear housing, the rack, and the tube. The main components of the valve section are the valve case, the pinion, the sleeve, and the stub shaft. The pinion and the stub shaft are linked to each other by the torsion bar.

When the stub shaft moves, the valve changes its position, switching the hydraulic passage from the pump to the cylinder in order to assist the steering operation.

Power Steering Pump Description

The power steering pump is a vane-type pump. The drive belt, coming from the crankshaft pulley, drives the power steering pump.

As the discharge rate of the power steering pump increases in proportion to the pump revolution speed, the power steering fluid pressure increases. The flow control valve controls the maximum amount of fluid pressure necessary for the steering operation.

Steering Wheel and Column - Standard Description and Operation

The steering wheel and column has 4 primary functions:

- Vehicle steering
- Vehicle security
- Driver convenience
- Driver safety

Vehicle Steering

The steering wheel is the first link between the driver and the vehicle. The steering wheel is fastened to a steering shaft within the column. At the lower end of the column, the intermediate shaft connects the column to the steering gear.

Vehicle Security

Theft deterrent components are mounted and designed into the steering column. The following components allow the column to be locked in order to minimize theft:

- The ignition switch
- The steering column lock
- The ignition cylinder

Driver Convenience

The steering wheel and column may also have driver controls attached for convenience and comfort. The following controls may be mounted on or near the steering wheel or column.

- The turn signal switch
- The hazard switch
- The headlamp dimmer switch
- The wiper/washer switch
- The horn pad/cruise control switch
- The redundant radio/entertainment system controls
- The tilt or tilt/telescoping functions
- The HVAC controls

Driver Safety

The energy-absorbing steering column compresses in the event of a front-end collision, which reduces the chance of injury to the driver. The mounting capsules break away from the mounting bracket in the event of an accident.

Suspension Description and Operation

Front Suspension

The front suspension is a strut type independent suspension. The upper end of a strut is anchored to the body by a strut support. The strut and the strut support are isolated by a rubber mount. The lower end of the strut is bolted to the upper end of a steering knuckle. The lower end of the knuckle is anchored to the front lower control arm by a ball joint.

The coil spring is separate from the strut. The upper end of the coil spring is anchored to the body by a spring seat. The lower end of the coil spring is on the front lower control arm.

The front stabilizer shaft is anchored to the 2 front lower control arms by 2 links. The shaft is anchored to the frame by 2 brackets. The shaft is isolated by 2 rubber insulators.

The front suspension support brace is anchored to the 2 strut housings. The brace increases body's structural rigidity.

4WD Front Suspension Sectional View(c)

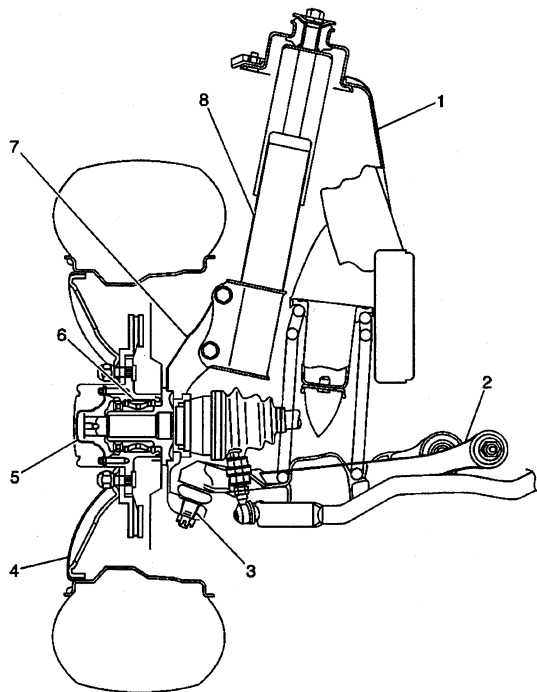

- (1) Vehicle Body
- (2) Front Lower Control Arm
- (3) Ball Stud
- (4) Wheel
- (5) Front Wheel Hub
- (6) Front Wheel Bearing
- (7) Steering Knuckle
- (8) Front Suspension Strut

2WD Front Suspension Sectional View(c)

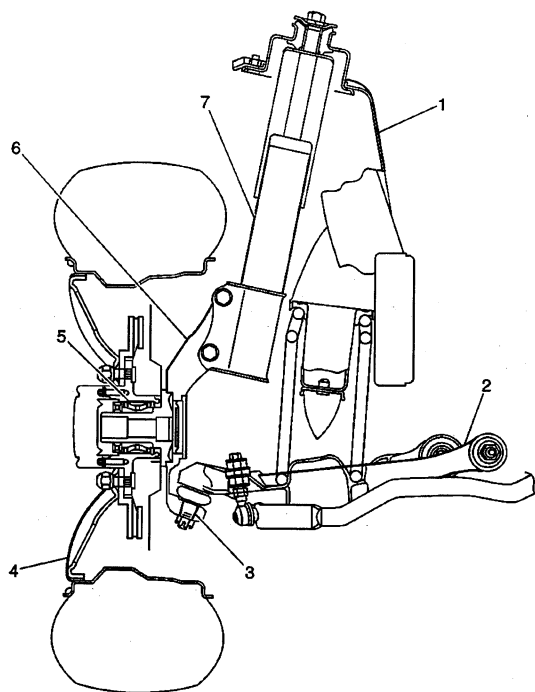

- (1) Vehicle Body
- (2) Front Lower Control Arm
- (3) Ball Stud
- (4) Wheel
- (5) Front Wheel Bearing
- (6) Steering Knuckle
- (7) Front Suspension Strut

Rear Suspension

The rear suspension is a coil sprung rigid axle located by 5 links. The rear suspension consists of the following components:

- 2 coil springs
- 2 shock absorbers
- 2 upper control arms
- 2 lower control arms
- A rear axle tie rod
- A rear axle

The rear axle tie rod controls lateral axle movement.

The lower control arms and the upper control arms control the vertical axle movement.

The shock absorbers dampen the vertical axle movement.

Rear Suspension(c)

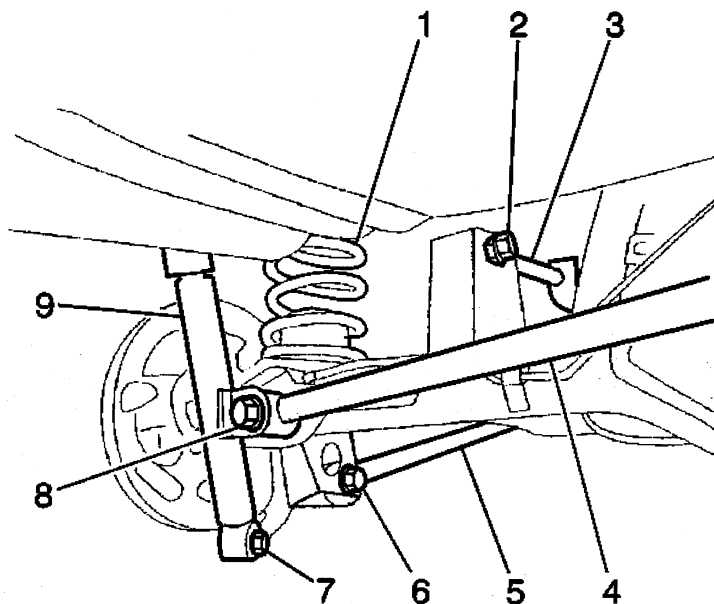

- (1) Coil Spring
- (2) Upper Control Arm Bolt
- (3) Rear Suspension Upper Control Arm
- (4) Rear Axle Tie Rod
- (5) Rear Suspension Lower Control Arm
- (6) Lower Control Arm Bolt
- (7) Rear Shock Absorber Lower Bolt
- (8) Tie Rod Bolt
- (9) Rear Shock Absorber

Rear Suspension and Rear Axle Sectional View(c)

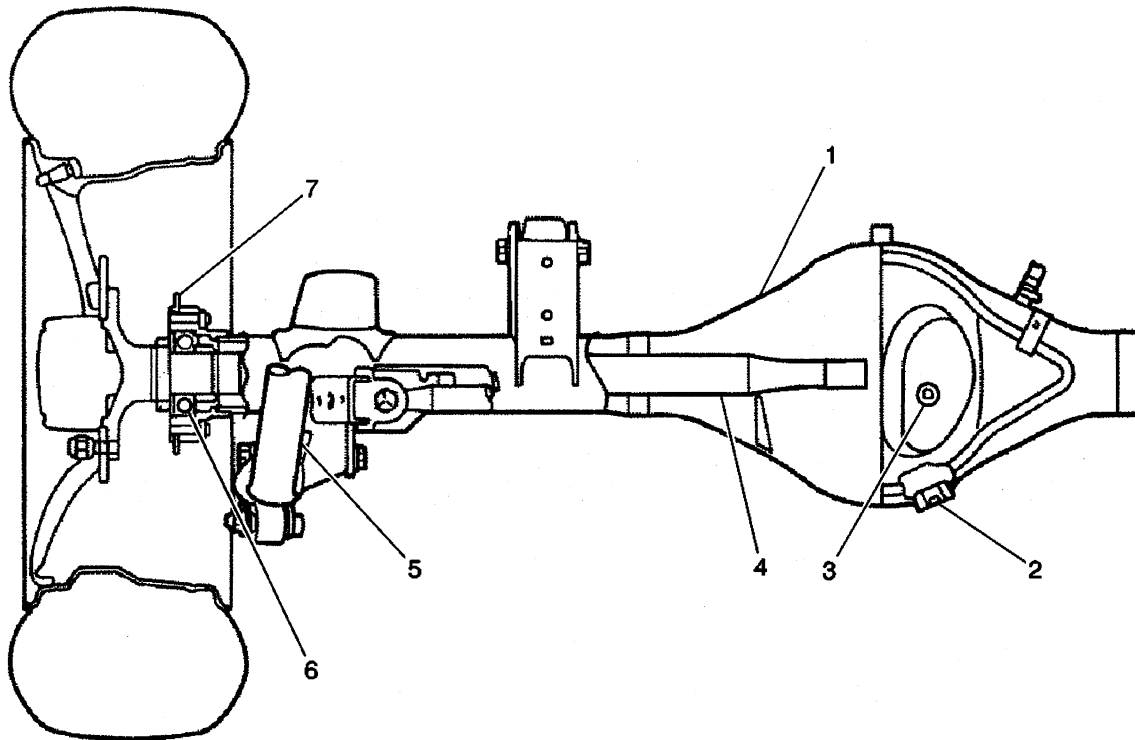

- (1) Rear Axle Housing
- (2) Oil Drain Plug
- (3) Oil Level Plug
- (4) Rear Axle Shaft
- (5) Shock Absorber
- (6) Rear Wheel Bearing
- (7) Brake Back Plate

Rear Suspension Side View(c)

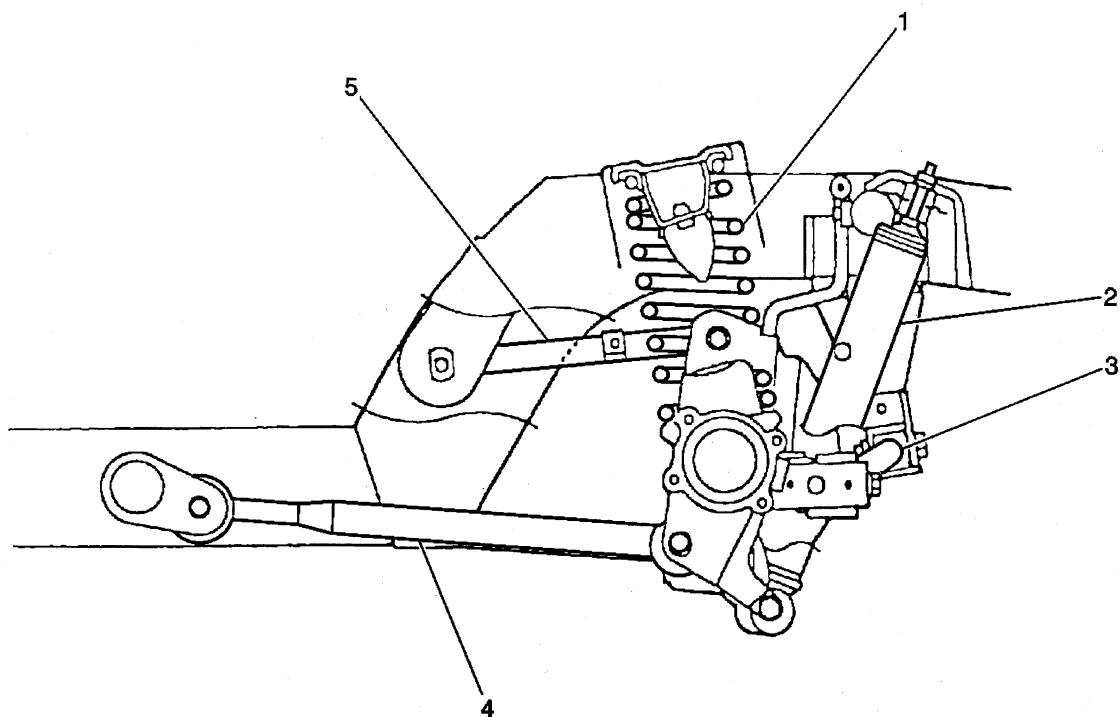

- (1) Coil Spring
- (2) Shock Absorber
- (3) Rear Axle Tie Rod
- (4) Rear Suspension Lower Control Arm
- (5) Rear Suspension Upper Control Arm

Wheels and Tires

General Description

The factory installed tires are designed to operate satisfactorily with loads up to and including the full rated load capacity when these tires are inflated to the recommended pressures.

The following factors have an important influence on tire life:

- Correct tire pressures
- Correct wheel alignment
- Proper driving techniques
- Tire rotation

The following factors increase tire wear:

- Heavy cornering
- Excessively rapid acceleration
- Heavy braking

Tread Wear Indicators Description

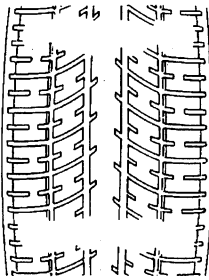

The original equipment tires have tread wear indicators that show when you should replace the tires.

The location of these indicators are at 72 degree intervals around the outer diameter of the tire. The indicators appear as a 6 mm (0.25 in) wide band when the tire tread depth becomes 1.6 mm (2/32 in).

Metric Wheel Nuts and Bolts Description

Metric wheel/nuts and bolts are identified in the following way:

- The wheel/nut has the word Metric stamped on the face.
- The letter M is stamped on the end of the wheel bolt.

The thread sizes of metric wheel/nuts and the bolts are indicated by the following example: M12 x 1.5.

- M = Metric
- 12 = Diameter in millimeters
- 1.5 = Millimeters gap per thread

Tire Inflation Description

When you inflate the tires to the recommended inflation pressures, the factory-installed wheels and tires are designed in order to handle loads to the tire's rated load capacity. Incorrect tire pressures, or under-inflated tires, can cause the following conditions:

- Vehicle handling concerns
- Poor fuel economy
- Shortened tire life
- Tire overloading

Inspect the tire pressure when the following conditions apply:

- The vehicle has been sitting at least 3 hours.
- The vehicle has not been driven for more than 1.6 km (1 mi).
- The tires are cool.

Inspect the tires monthly or before any extended trip. Adjust the tire pressure to the specifications on the tire label. Install the valve caps or the extensions on the valves. The caps or the extensions keep out dust and water.

The kilopascal (kPa) is the metric term for pressure. The tire pressure may be printed in both kilopascal (kPa) and psi. One psi equals 6.9 kPa.

Inflation Pressure Conversion (Kilopascals to PSI)

kPa	psi	kPa	psi
140	20	215	31
145	21	220	32
155	22	230	33
160	23	235	34
165	24	240	35
170	25	250	36
180	26	275	40
185	27	310	45
190	28	345	50
200	29	380	55
205	30	415	60
Conversion: 6.9 kPa = 1 psi			

Tires with a higher than recommended pressure can cause the following conditions:

- A hard ride
- Tire bruising
- Rapid tread wear at the center of the tire

Tires with a lower than recommended pressure can cause the following conditions:

- A tire squeal on turns
- Hard steering
- Rapid wear and uneven wear on the edge of the tread
- Tire rim bruises and tire rim rupture
- Tire cord breakage
- High tire temperatures
- Reduced vehicle handling
- High fuel consumption
- Soft riding

Unequal pressure on the same axle can cause the following conditions:

- Uneven braking
- Steering lead
- Reduced vehicle handling

P-Metric Sized Tires Description

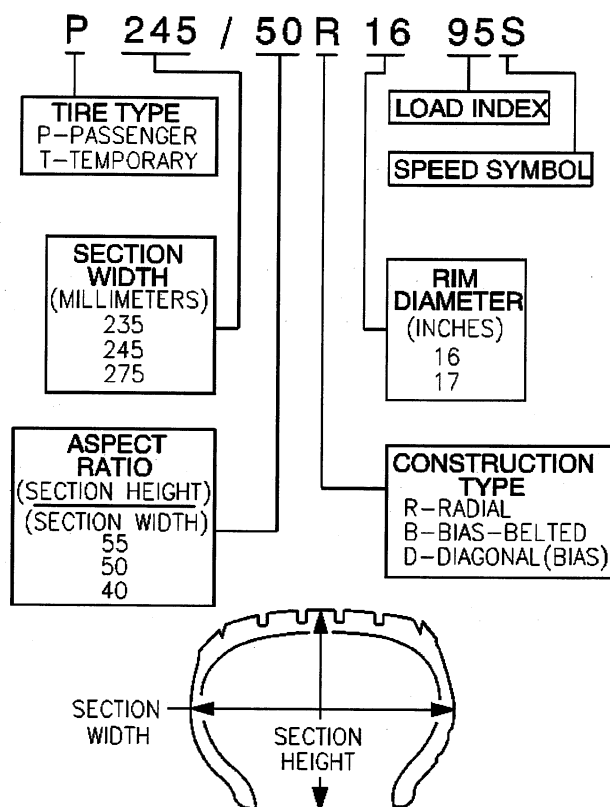

Most P-metric tire sizes do not have exact corresponding alphanumeric tire sizes. Replacement tires should be of the same tire performance criteria (TPC) specification number including the same size, the same load range, and the same construction as those originally installed on the vehicle. Consult a tire dealer if you must replace the P-metric tire with other sizes. Tire companies can best recommend the closest match of alphanumeric to P-metric sizes within their own tire lines.

Driveline System Description and Operation

Driveline/Axle – Propeller Shaft

Front and Rear Propeller Shaft

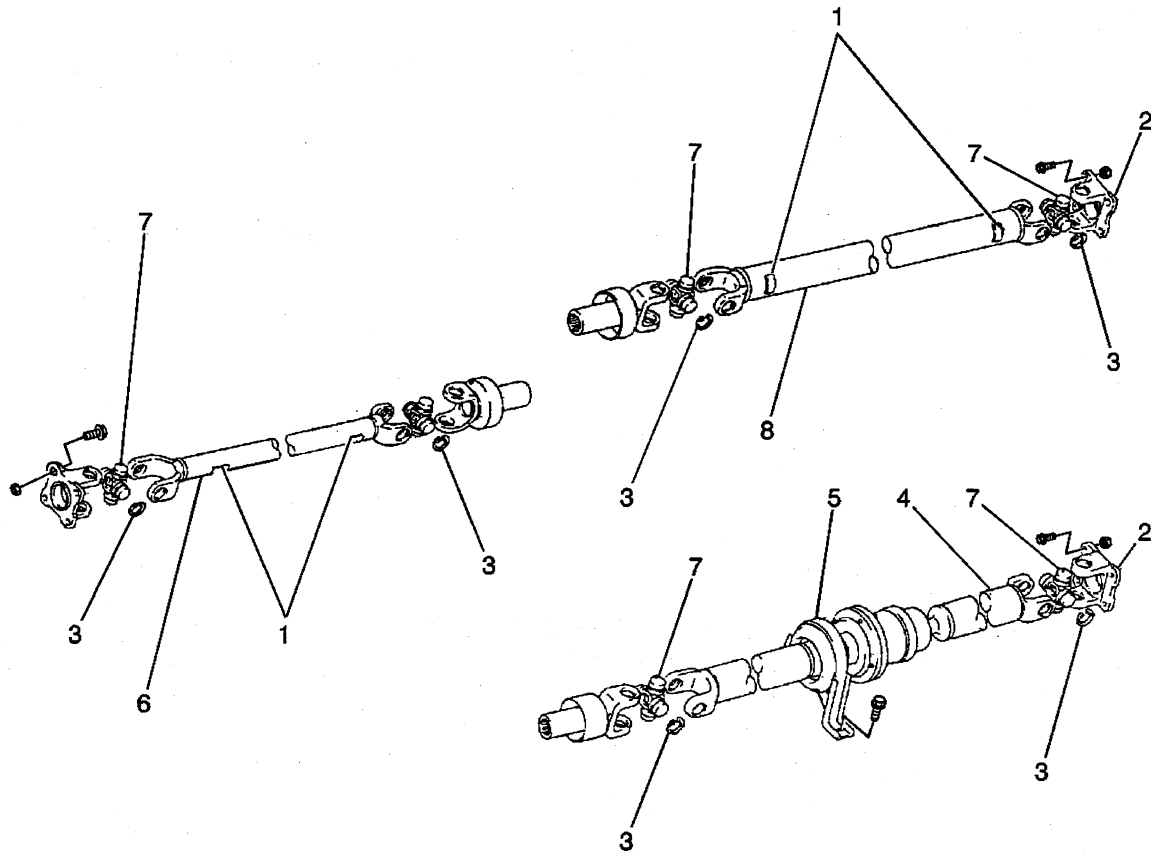

- (1) Balance Weight
- (2) Pinion Flange Yoke
- (3) Snap Ring
- (4) 2 Piece Propeller Shaft (4 Door 2WD Equipped)
- (5) Center Support and Center Support Bearing (4 Door 2WD Equipped)
- (6) Front Propeller Shaft (4WD Equipped)
- (7) Universal Joint
- (8) Rear Propeller Shaft

The propeller shaft is a balanced cylindrical shaft which transfers engine torque from the transmission or transfer case to the front or rear differential carrier through universal joints (7). The number of propeller shafts and universal joint assemblies can be either one propeller shaft and 2 universal joint assemblies (two-wheel drive), or 2 propeller shafts and 4 universal joint assemblies (four-wheel drive). The sliding

yoke is splined to the transmission or transfer case output shaft. The sliding yoke permits fore and aft movement of the propeller shaft as the differential moves up or down with suspension movement. The splines are lubricated internally by transmission or transfer case lubricant.

The pinion flange yoke (2) is bolted to the differential pinion flange and needs no lubrication. The propeller shaft is designed and built with the yoke lugs in line with each other. This design produces the smoothest running shaft possible and is known as phasing. The propeller shaft will absorb vibrations from speeding up and slowing on each revolution of the universal joints. A total cancellation of vibration produces a smooth flow of power through the driveline.

When servicing the propeller shaft and its components, exercise care during removal and installation procedures to make sure the propeller shaft is installed in the same position from which it was removed. It is necessary to make index marks (reference marks) on the propeller shaft pinion flange yoke and the differential pinion flange before removing them to ensure correct installation and alignment. If this precaution is not observed, a driveline imbalance may result, causing vibration, premature component wear or other problems.

Universal Joint Description

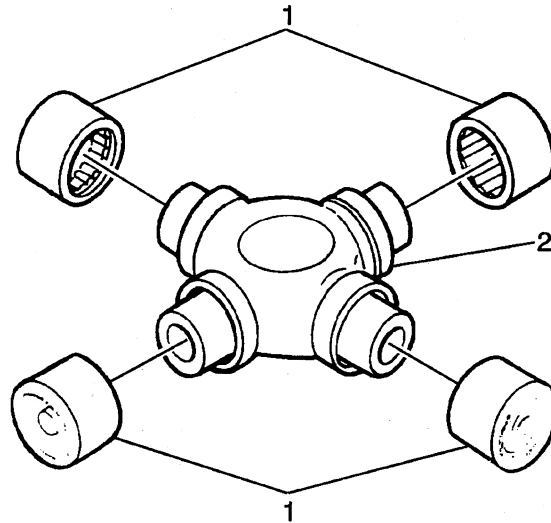

A universal joint consists of bearing assemblies connected by a crossmember called a spider (2). The spider is shaped like a cross and has arms of equal length. The bearings used in universal joints are the needle roller type and revolve around the ends of the spider inside bearing caps which act as races. The bearing caps (1) are fitted into the propeller shaft yokes and are held in place with snap rings. The universal joint is designed to handle the effects of various loadings and axle windup during acceleration.

The universal joints will operate safely and efficiently within design angle variations. When the design angle is changed or exceeded, the operational life of the joint may decrease. Universal joints are lubricated and sealed during manufacturing and do not require maintenance. If a universal joint becomes noisy or worn, it must be replaced as an assembly.

Wheel Drive Shafts

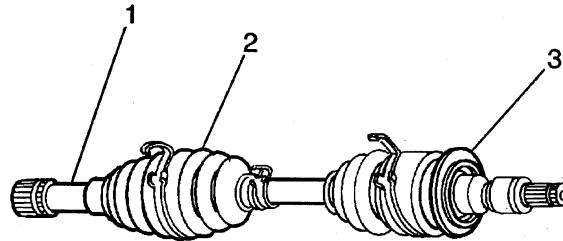

The front drive axle shaft is a flexible assembly consisting of an inner and outer Constant Velocity (CV) joint joined by an axle shaft (1). The inner or differential-side CV joint is a double offset design which is completely flexible and has the capability of an in and out movement. The outer or wheel-side CV joint (2) is a ball joint design that is completely flexible, but cannot move in and out.

Front Drive Axle Description and Operation

The front axle assembly consists of the following:

- Front axle housing
- Differential carrier
- Left inner axle shaft
- Left drive axle shaft
- Right drive axle shaft

The front axle housing is mounted to the vehicle frame. The differential carrier is mounted in the right side of the front axle housing. The front propeller shaft turns the differential assembly which transfers engine power when in 4WD mode to the right and left drive axle shafts. The front axle housing is sealed and contains a synthetic gear lubricant which lubricates the differential assembly, left inner axle shaft and its support bearing. The front axle housing is also vented to prevent excessive heat buildup.

The differential assembly utilizes a hypoid beveled ring and pinion gear set. It consists of a ring gear which is mounted to the differential case, a pinion gear which is mounted in the differential carrier, and a set of four gears mounted inside the differential case. Two of these gears are known as side gears and the other two are known as differential pinion gears. The right side gear is splined to the right drive axle shaft, and the left side gear is splined to the left inner axle shaft.

At the end of the left inner axle shaft is a flange which bolts to a similar flange at the differential-side joint of the left drive axle shaft. Because these shafts are splined to the differential side gears, the right drive axle and the left inner axle shaft rotate as their respective side gear rotates. The differential pinion gears are mounted on a pinion shaft and are free to rotate on it. The pinion shaft is fitted into bores in the differential case and is held in place by a roll pin. The differential case is mounted in the differential carrier where the pinion gear drives the ring gear, differential case, and its side and differential pinion gears.

Front Axle Operation

When the transfer case is placed in 4WH or 4WL, the electric motor actuator turns on and builds pressure. When the pressure reaches the specific amount (within seconds) the actuator engages and locks the differential into the drive mode. Engine torque is provided by the front propeller shaft. The propeller shaft is bolted to the pinion flange by a universal joint. The pinion gear turns the ring gear and differential case, which causes the side gears to rotate with the case. This action in turn causes the left inner axle shaft and the right drive axle shaft to rotate and drive the front wheels. When both wheels have equal traction, the differential pinion gears do not rotate on the pinion shaft. This is due to an input force which is equally divided between the side gears. In other words, the differential pinion gears revolve with the pinion shaft, but do not rotate around it. When the vehicle turns a corner, the outer drive axle must turn faster than the inner drive axle. When the inner drive axle turns slower than the outer, it slows its side gear. The differential pinion gears will roll around the slower drive axle side gear providing torque to the outer drive axle. When the transfer case is placed in 2WH or N, the front axle is disengaged and the front propeller shaft as well as all front axle components remain stationary while the front wheels are free to rotate.

Rear Drive Axle Description and Operation

The rear axle assembly contains two rigid axle shafts which transfer engine torque to the rear wheels. These axle shafts are supported in the rear axle housing by bearings at both outer ends, and driven by the differential assembly which is mounted in the center of the rear axle housing. A propeller shaft turns the differential assembly and transfers power to the rear axle shafts. The rear axle housing is sealed and contains a synthetic gear lubricant which lubricates the differential assembly and axle shafts bearings. The rear axle housing is also vented to prevent excessive heat buildup. The rear trailing rods connect the rear axle housing to the frame and act as pivot points for the housing as it moves up and down with the rear suspension. Coil springs support the rear of the vehicle and are seated into the frame and rear axle housing axle. Shock absorbers are fitted between the rear axle housing and the frame to help to reduce road vibration and rough pavement. An upper control arm is fitted to the body by bushings, and to the rear differential carrier by a rear control arm ball joint to prevent the rear axle housing from moving in a lateral direction.

The differential assembly uses a hypoid, beveled ring and pinion gear set. It consists of a ring gear which is mounted to the differential case and a pinion gear which is mounted in the differential carrier. The ring and pinion gears are in constant mesh with each other. A set of six gears are mounted inside the differential case. Two of these gears are known as side gears and the other four are known as differential pinion gears. Each side gear is splined to an axle shaft which causes each axle shaft to turn when its side gear rotates. The differential pinion gears are mounted on a pinion cross shaft and are free to rotate on it. The pinion shaft is fitted into a bore in the differential case and is held in place by a pinion shaft roll pin. The differential case is mounted in the differential carrier where the pinion gear drives the ring gear, differential case, and the side and differential pinion gears. The differential carrier is mounted near the center of the rear axle housing.

Engine torque is provided by a rear propeller shaft that is bolted to the pinion gear by a universal joint and pinion flange. The pinion gear is in constant mesh with the ring gear and causes it to turn. The ring gear then rotates the differential case causing the differential pinion gears to turn with the case. This causes the side gears and both rear axle shafts to rotate. When both wheels have equal traction, the pinion gears do not rotate on the cross shaft. This is due to an input force that is equally divided between the side gears. In other words, the pinion gears revolve with the cross shaft but do not rotate around it. When the vehicle turns a corner, the outer axle must turn faster than the inner axle. When the inner axle turns slower than the outer, it slows its side gear. The differential pinion gears will roll around the slower side gear providing torque to the outer axle shaft.

Rear Wheel Speed Sensor (ABS)

A four-wheel antilock braking system is optional equipment on this vehicle. The rear wheel speed sensor is mounted on the rear differential carrier. The rear wheel speed sensor consists of a magnetic core, with

a magnet and a coil. The speed sensor exciter ring is mounted on the differential case behind the ring gear and rotates with the case. An electrical impulse is produced each time a gear tooth of the speed sensor exciter ring passes the rear wheel speed sensor, allowing the sensor to receive a signal in direct proportion to the rear axle speed. This signal is then sent to the Electronic Brake Control Module (EBCM). For more information and diagnostic procedures, refer to Antilock Brake System.

Transfer Case Description

Vehicles equipped with 4WD, the transfer case, located at the rear of the transmission, is responsible for transferring engine torque to the front and rear wheels. The transfer case contains an input gear, countershaft and counter gear, rear output shaft, low output gear and a front output shaft (for front drive) connected and driven by a drive chain.

The transfer case gearshift control lever can be placed in four positions: 4H (direct connection with the input gear, counter gear and low output gear), N (by way of the reduction clutch sleeve located between the input gear and the low output gear) and 2H (high speed to the rear wheels only). The front drive shift fork mechanism also has an auxiliary spring to ensure a smooth shift from 4H to 2H.

You can shift from 2H to 4H or from 4H to 2H at any speed if your vehicle is going less than 60 mph (100 kph) and your wheels are straight ahead. Your front axle will engage faster if you take your foot off the accelerator pedal for a few seconds as you shift.

Braking System Description and Operation

Hydraulic Brake System Description and Operation

System Component Description

The hydraulic brake system consists of the following:

Hydraulic Brake Master Cylinder Fluid Reservoir

Contains supply of brake fluid for the hydraulic brake system.

Hydraulic Brake Master Cylinder

Converts mechanical input force into hydraulic output pressure.

Hydraulic output pressure is distributed from the master cylinder through two hydraulic circuits, supplying diagonally-opposed wheel apply circuits.

Hydraulic Brake Pressure Balance Control System

Regulates brake fluid pressure delivered to hydraulic brake wheel circuits, in order to control the distribution of braking force.

Pressure balance control is achieved through dynamic rear proportioning (DRP), which is a function of the ABS modulator.

Hydraulic Brake Pipes and Flexible Brake Hoses

Carries brake fluid to and from hydraulic brake system components.

Hydraulic Brake Wheel Apply Components

Converts hydraulic input pressure into mechanical output force.

System Operation

Mechanical force is converted into hydraulic pressure by the master cylinder, regulated to meet braking system demands by the pressure balance control system, and delivered to the hydraulic brake wheel circuits by the pipes and flexible hoses. The wheel apply components then convert the hydraulic pressure back into mechanical force which presses linings against rotating brake system components.

Brake Assist System Description and Operation

System Component Description

The brake assist system consists of the following:

Brake Pedal

Receives, multiplies and transfers brake system input force from driver.

Brake Pedal Pushrod

Transfers multiplied input force received from brake pedal to brake booster.

Vacuum Brake Booster

Uses source vacuum to decrease effort required by driver when applying brake system input force.

When brake system input force is applied, air at atmospheric pressure is admitted to the rear of both vacuum diaphragms, providing a decrease in brake pedal effort required. When input force is removed, vacuum replaces atmospheric pressure within the booster.

Vacuum Source

Supplies force used by vacuum brake booster to decrease brake pedal effort.

Vacuum Source Delivery System

Enables delivery and retention of source vacuum for vacuum brake booster.

System Operation

Brake system input force is multiplied by the brake pedal and transferred by the pedal pushrod to the hydraulic brake master cylinder. Effort required to apply the brake system is reduced by the vacuum brake booster.

Disc Brake System Description and Operation

System Component Description

The disc brake system consists of the following components:

Disc Brake Pads

Applies mechanical output force from the hydraulic brake calipers to friction surfaces of brake rotors.

Disc Brake Rotors

Uses mechanical output force applied to friction surfaces from the disc brake pads to slow speed of tire and wheel assembly rotation.

Disc Brake Pad Hardware

Secures disc brake pads firmly in proper relationship to the hydraulic brake calipers. Enables a sliding motion of brake pads when mechanical output force is applied.

Disc Brake Caliper Hardware

Provides mounting for hydraulic brake caliper and secures the caliper firmly in proper relationship to caliper bracket. Enables a sliding motion of the brake caliper to the brake pads when mechanical output force is applied.

System Operation

Mechanical output force is applied from the hydraulic brake caliper pistons to the inner brake pads. As the pistons press the inner brake pads outward, the caliper housings draw the outer brake pads inward. This allows the output force to be equally distributed. The brake pads apply the output force to the friction surfaces on both sides of the brake rotors, which slows the rotation of the tire and wheel assemblies. The correct function of both the brake pad and brake caliper hardware is essential for even distribution of braking force.

Drum Brake System Description and Operation

System Component Description

The drum brake system consists of the following:

Drum Brake Shoes

Applies mechanical output force (from hydraulic brake wheel cylinders) to friction surface of brake drums.

Brake Drums

Uses mechanical output force applied to friction surface from drum brake shoes to slow speed of tire and wheel assembly rotation.

Drum Brake Hardware

Secures drum brake shoes firmly in proper relationship to hydraulic brake wheel cylinders. Enables sliding motion of brake shoes needed to expand toward friction surface of drums when mechanical output force is applied; provides return of brake shoes when mechanical output force is relieved.

Drum Brake Adjusting Hardware

Provides automatic adjustment of brake shoes to brake drum friction surface whenever brake apply occurs during rearward motion of the vehicle.

System Operation

Mechanical output force is applied from the hydraulic brake wheel cylinder pistons to the top of the drum brake shoes. The output force is then distributed between the primary and secondary brake shoes as the shoes expand toward the friction surface of the brake drums. The brake shoes apply the output force to the friction surface of the brake drums, which slows the rotation of the tire and wheel assemblies. The proper function of both the drum brake hardware and adjusting hardware is essential to the proper distribution of braking force.

Park Brake System Description and Operation

System Component Description

The park brake system consists of the following:

Park Brake Lever Assembly

Receives, multiplies, and transfers park brake system apply input force from operator to park brake cable system.

Releases applied park brake system when lever is returned to at-rest, lowered, position.

Park Brake Cables

Transfers input force received from park brake lever, through park brake cable equalizer, to park brake apply levers.

Park Brake Cable Equalizer

Evenly distributes input force to both the left and right park brake units.

Park Brake Apply Lever

Multiplies and transfers input force to park brake actuator/adjuster.

Park Brake Actuator/Adjuster

Uses multiplied input force from apply lever to expand drum brake shoes toward the friction surface of the brake drum.

Threaded park brake actuators/adjusters are also used to control clearance between the drum brake shoes and the friction surface of the brake drum.

Drum Brake Shoes

Applies mechanical output force from park brake actuator/adjuster to friction surface of the brake drum.

System Operation

Park brake apply input force is received by the park brake lever assembly being applied. The input force is multiplied by the lever assembly, transferred, and evenly distributed, through the park brake cables and the park brake cable equalizer, to the left and right park brake apply levers. The park brake apply levers multiply and transfer the apply input force to the park brake actuators/adjusters which expand the drum brake shoes toward the friction surface of the brake drum in order to prevent the rotation of the rear tire and wheel assemblies. The park brake lever assembly releases an applied park brake system when it is returned to the at-rest, lowered, position.

ABS Description and Operation

Antilock Brake System

When wheel slip is detected during a brake application, the ABS enters antilock mode. During antilock braking, hydraulic pressure in the individual wheel circuits is controlled to prevent any wheel from slipping. A separate hydraulic line and specific solenoid valves are provided for each wheel. The ABS can decrease, hold, or increase hydraulic pressure to each wheel brake. The ABS cannot, however, increase hydraulic pressure above the amount which is transmitted by the master cylinder during braking.

During antilock braking, a series of rapid pulsations is felt in the brake pedal. These pulsations are caused by the rapid changes in position of the individual solenoid valves as the EBCM responds to wheel speed sensor inputs and attempts to prevent wheel slip. These pedal pulsations are present only during antilock braking and stop when normal braking is resumed or when the vehicle comes to a stop. A ticking or popping noise may also be heard as the solenoid valves cycle rapidly. During antilock braking on dry pavement, intermittent chirping noises may be heard as the tires approach slipping. These noises and pedal pulsations are considered normal during antilock operation.

Vehicles equipped with ABS may be stopped by applying normal force to the brake pedal. Brake pedal operation during normal braking is no different than that of previous non-ABS systems. Maintaining a constant force on the brake pedal provides the shortest stopping distance while maintaining vehicle stability.

Engine Description and Operation

Engine Mechanical Specifications – 1.6L

Application	Specification	
	Metric	English
General		
• Engine Type	L4	
• RPO Code	L01	
• Displacement	1600 cc	97 CID
• Bore	75 mm	2.95 in
• Stroke	90 mm	3.54 in
• Compression Ratio	9.5:1	
• Firing Order	1-3-4-2	
• Spark Plug Type-AC	R43XLS	
• Spark Plug Gap	0.7-0.8 mm	0.028-0.032 in
Lubrication System		
• Oil Pressure (at 4000 RPM)	330-430 kPa	46.9-61.1 psi
• Oil Capacity with Filter Change	4.2L	4.5 qt
Cooling System		
• Cooling System Capacity	5.3L	5.6 qt
• Temperature at which Thermostat begins to Open	83°C	179°F
• Temperature at which Thermostat Fully Open	95°C	203°F
• Thermostat Valve Lift	More than 8 mm at 95°C (203°F)	
• Radiator Cap Relief Valve Pressure	108 kPa	15.7 psi

Fastener Tightening Specifications – 1.6L

Application	Specification	
	Metric	English
Air Cleaner (ACL) Mounting Bolts	10 N·m	89 lb in
Air Conditioner (A/C) Compressor Flexible Hose Mounting Bolts	10 N·m	89 lb in
Air Conditioner (A/C) Mounting Bracket Bolts	10 N·m	89 lb in
Air Intake Pipe Bolts	10 N·m	89 lb in
Air Intake Pipe Bracket Bolts	15 N·m	11 lb ft
Camshaft Housing Bolts	10 N·m	89 lb in
Camshaft Sensor Bolt	10 N·m	89 lb in
Camshaft Sensor Housing Bolts	10 N·m	89 lb in
Camshaft Timing Sprocket Bolt	60 N·m	44 lb ft
Connecting Rod Bearing Cap Nuts	35 N·m	26 lb ft
Coolant Intake Pipe Bolt	11 N·m	97 lb in
Coolant Pump Bolts	12 N·m	106 lb in
Coolant Pump Pulley Nuts	11 N·m	97 lb in
Crankshaft Pulley Bolts	16 N·m	12 lb ft
Crankshaft Timing Sprocket Bolt	110 N·m	81 lb ft
Cylinder Head Bolts		
• First Pass	35 N·m	26 lb ft
• Second Pass	55 N·m	41 lb ft
• Third Pass (Final Torque)	70 N·m	52 lb ft
Cylinder Head Cover Bolts	10 N·m	89 lb in
Engine Mount Bracket Bolts (Engine Side)	50 N·m	37 lb ft

Engine Mount Bracket Bolts (Body Side)	85 N·m	62 lb ft
Engine Mount Nuts	50 N·m	37 lb ft
Engine Oil Drain Plug	35 N·m	26 lb ft
Engine Oil Pan Nuts and Bolts	11 N·m	97 lb in
Exhaust Bracket-to-Exhaust Manifold Nut	50 N·m	37 lb ft
Exhaust Manifold Nuts	23 N·m	17 lb ft
Exhaust Manifold Heat Shield Bolts and Nuts	10 N·m	89 lb in
Exhaust Manifold-to-Cylinder Head Bolts and Nuts	23 N·m	17 lb ft
Exhaust Manifold-to-Front Pipe/Three Way Catalytic Converter (TWC) Assembly Bolts	50 N·m	37 lb ft
Exhaust Pipe-to-Bracket Nut	50 N·m	37 lb ft
Fan Clutch Nuts	11 N·m	97 lb in
Flywheel Retaining Bolts	78 N·m	58 lb ft
Front End Panel Bolts	10 N·m	89 lb in
Front Pipe/TWC Assembly-to-Exhaust Manifold Bolts	50 N·m	37 lb ft
Front Pipe/TWC Assembly-to-Resonator/Center Pipe Nuts	35 N·m	26 lb ft
Front Skid Plate Bolts	55 N·m	40 lb ft
Generator Adjusting Arm Bracket Nut and Bolt	23 N·m	17 lb ft
Generator Mounting Bolts and Nuts	23 N·m	17 lb ft
Guide Tube Bolts	14 N·m	10 lb ft
Heated Oxygen (HO2S1) Sensor	43 N·m	32 lb ft
Hood Latch Bolts	10 N·m	89 lb in
Ignition Coil Bolts	3 N·m	27 lb in
Intake Manifold Nuts and Bolts	23 N·m	17 lb ft
Intake Manifold Support Bracket Bolts	50 N·m	37 lb ft
Main Bearing Cap Bolts	54 N·m	40 lb ft
Oil Jet	5 N·m	44 lb in
Oil Pressure Switch	14 N·m	10 lb ft
Oil Pump Bolts	11 N·m	97 lb in
Oil Pump Strainer Bolt	11 N·m	97 lb in
Oil Pump Strainer Bracket Bolt	11 N·m	97 lb in
Rear Main Seal Housing Bolts	12 N·m	106 lb in
Rocker Arm Shaft Bolts	10 N·m	89 lb in
Rocker Arm Shaft Plug	33 N·m	24 lb ft
Shroud Bolts	11 N·m	97 lb in
Timing Belt Cover Nut and Bolts	10 N·m	89 lb in
Timing Belt Inside Cover Bolts	10 N·m	89 lb in
Timing Belt Tensioner Bolt	27 N·m	20 lb ft
Timing Belt Tensioner Stud	11 N·m	97 lb in
Throttle Body Nuts and Bolts	23 N·m	17 lb ft
Throttle Cover Bolts	15 N·m	11 lb ft

Engine Component Description 1.6L

Cylinder Block

The cylinder block is an aluminum casting with four cast iron cylinder sleeves. The cylinder block has four in-line cylinders which are numbered 1 through 4 starting from the crankshaft pulley. The cylinder block contains coolant jackets through which coolant flows around the cylinders, to cool the cylinder block and maintain a constant operating temperature.

Crankshaft

The crankshaft is cast nodular iron with eight counterweights. Oil holes run through the center of the crankshaft to supply oil to the connecting rods, bearings, pistons and other components. The end thrust load is taken by the thrust washers installed at the center number three bearing journal.

Connecting Rod and Piston

The connecting rods are forged steel, heat treated and shot peened. The connecting rod incorporates the full-floating type pin. The pistons are cast aluminum. The piston rings are of a low tension type to reduce friction. The top compression ring is plated with chromium for abrasion resistance. The second compression ring is gray iron. The oil ring is a 3-piece spring construction.

Oil Pan

The oil pan is constructed of stamped steel and is mounted to the lower crankcase. The oil pan includes a baffle that helps prevent the oil from shifting away from the oil pump suction pipe during hard turns, acceleration or stopping.

Cylinder Head

The cylinder head is an aluminum casting with pressed-in valve guides and valve seat insets. The fuel injection nozzles are located in the intake ports.

Valves

There are two intake and two exhaust valves per cylinder. There are two valve springs per valve. Positive valve stem seals are used on all valves.

Camshaft

There is one camshaft that is used to operate all 16 valves. The camshaft is made of cast iron.

Camshaft Drive

The camshaft is belt driven and a mechanical tensioner is used to retain the proper timing belt tension.

Intake and Exhaust Manifold

The intake manifold is made of aluminum. The exhaust manifold is cast iron.

Engine Lubrication – 1.6L

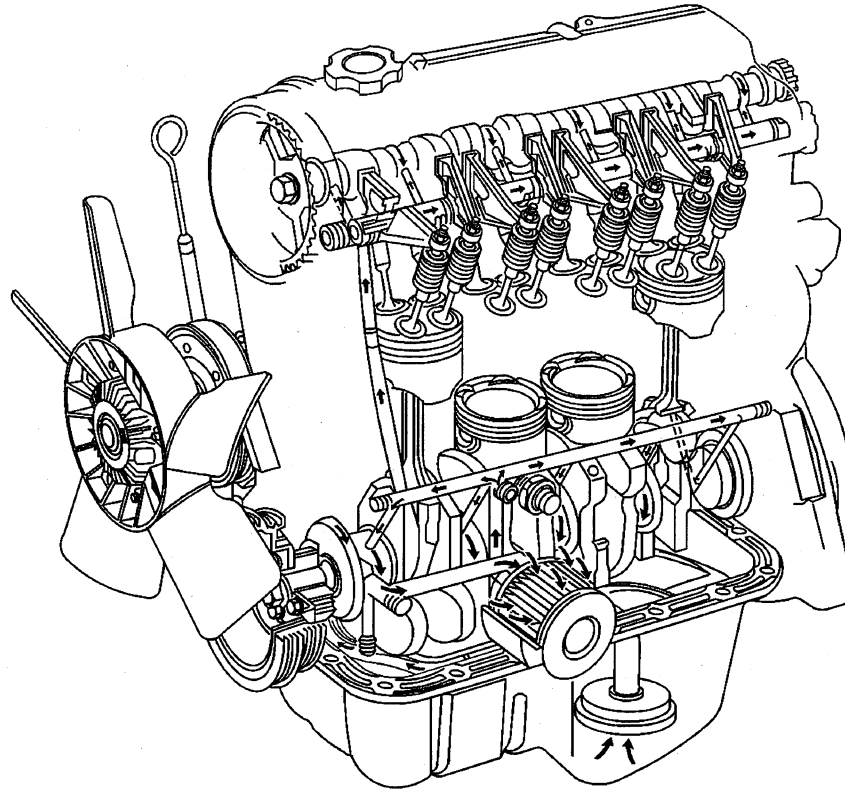

The lubrication system consists of an oil pan, oil pump screen, oil pump, oil filter and oil pressure regulator. This pressure-fed lubrication system supplies oil to the moving parts of the engine.

The oil pump picks up oil from the oil pan and feeds it under pressure to the various parts of the engine. An oil strainer is mounted before the inlet to the oil pump to remove impurities which could clog or damage the oil pump or other engine components. The oil pump itself is a trochoid gear type pump with internal drive and driven gears. When the drive rotates, the driven gear rotates in the same direction, but on a different center point. This causes the space between the gears to constantly open and narrow, pulling oil in from the oil pan when the space opens and pumping the oil out to the engine as it narrows.

The oil filter is a full flow type with a relief valve built into the paper filter element. Contaminants which can get into the oil during operation could cause accelerated engine wear or seizing if allowed into the engine. The oil filter, situated at the beginning of the oil passage circuit, removes these contaminants as the oil passes through it. The relief valve spring will open under the pressure of the oil and allow oil to bypass the filter and flow directly to the engine.

At high engine speeds, the oil pump supplies a much higher amount of oil than required for lubrication of the engine. The oil pressure regulator prevents too much oil from entering the engine lubrication passages. During normal oil supply, a coil spring and valve keeps the bypass closed, directing all oil pumped to the engine. When the amount of oil being pumped increases, the pressure becomes high enough (420 kPa (60 psi)) to overcome the force of the spring, opening the valve and allowing excess oil to flow through the valve and drain back to the oil pan.

Oil is pumped from the oil pan by the oil pump. After it passes through the oil filter, it is fed through two paths to lubricate the cylinder block and cylinder head.

In one path, the oil is pumped through oil passages in the crankshaft to the connecting rods, then to the pistons and cylinders. It then drains back to the oil pan.

In the second path, the oil is pumped through passages to the camshaft and the hydraulic valve lash adjusters. The oil passes through internal passageways in the camshafts to lubricate the valve assemblies before draining back to the oil pan.

Engine Mechanical Specifications – 2.0L

Application	Specification	
	Metric	English
General:		
• Engine Type	L4	
• RPO Code	L34	
• Displacement	1995 cc	122 CID
• Bore	84 mm	3.31 in
• Stroke	90 mm	3.54 in
• Compression Ratio	9.7:1	
• Firing Order	1-3-4-2	
• Spark Plug Type-Denso	SK16PR11 or PK16PR11	
• Spark Plug Type-NGK	IFR5G11 or PFR5G-11	
• Spark Plug Gap	1.0-1.1 mm	0.039-0.043 in
Lubrication System:		
• Oil Pressure at 4000 RPM	390-470 kPa	55.5-66.8 psi
• Oil Capacity with Filter Change	5.2 L	5.5 qt
• Oil Capacity without Filter Change	5.0 L	5.2 qt
Cooling System:		
• Cooling System Capacity	6.5 L	6.9 qt
• Temperature at which Thermostat begins to Open	83°C	179°F
• Temperature at which Thermostat Fully Open	95°C	203°F
• Thermostat Valve Lift	8 mm at 95°C	0.32 in at 203°F
• Radiator Cap Relief Valve Pressure	108 kPa	15.7 psi
• Temperature at which Fan Clutch begins to Engage	50-70°C	122-158°F

Fastener Tightening Specifications – 2.0L

Application	Specification	
	Metric	English
Air Cleaner (ACL) Mounting Bolts	10 N·m	89 lb in
Air Conditioner (A/C) Compressor Mounting Bolts	23 N·m	17 lb ft
Air Conditioner (A/C) Compressor Bracket Mounting Bolts	55 N·m	40 lb ft
Camshaft Bearing Cap Bolts	11 N·m	97 lb in
Camshaft Position Sensor Bolt	15 N·m	11 lb ft
Camshaft Timing Sprocket Bolts	80 N·m	58 lb ft
Connecting Rod Bearing Cap Nuts	45 N·m	33 lb ft
Coolant Bypass Pipe to Cylinder Head Bolt	15 N·m	11 lb ft
Crankshaft Position Sensor Bolt	6 N·m	53 lb in
Crankshaft Pulley Bolt	150 N·m	109 lb ft
Cylinder Head Cover Bolts	11 N·m	97 lb in
Cylinder Head Bolts		
• First Pass	53 N·m	39 lb ft
• Second Pass	84 N·m	61 lb ft

2000 Chevrolet Tracker Restoration Kit

• Third Pass	Loosen to 0	
• Fourth Pass	53 N·m	39 lb ft
• Fifth Pass	84 N·m	61 lb ft
• Sixth Pass (Final Torque)	105 N·m	76 lb ft
Cylinder Head M 6 Bolt	11 N·m	97 lb in
Drive Belt Idler Pulley Nut	45 N·m	33 lb ft
Drive Belt Tensioner Bolts		
• Cooling Fan Drive Belt Tensioner Bolts	45 N·m	33 lb ft
• Accessory Drive Belt Tensioner Bolts	25 N·m	19 lb ft
Engine Cooling Fan Nuts	11 N·m	97 lb in
Engine Ground Wire Bolts	15 N·m	11 lb ft
Engine Mount Bracket Bolts (Engine Side)	50 N·m	37 lb ft
Engine Mount Bracket Bolts (Body Side)	85 N·m	62 lb ft
Engine Mount Nuts	50 N·m	37 lb ft
Engine Oil Drain Plug	35 N·m	26 lb ft
Engine Oil Pan Nuts and Bolts	11 N·m	97 lb in
Exhaust Manifold Flange Bolts	50 N·m	37 lb ft
Exhaust Manifold Heat Shield Bolts	15 N·m	11 lb ft
Exhaust Manifold-to-Cylinder Head Nuts	50 N·m	37 lb ft
Exhaust Manifold-to-Bracket Bolts	50 N·m	37 lb ft
Exhaust Pipe PUP Catalytic Converter Clamp Bolt	50 N·m	37 lb ft
Fuel Rail to Cylinder Head Bolts	23 N·m	17 lb ft
Fuel Rail Banjo Fitting	30 N·m	22 lb ft
Flywheel Retaining Bolts		
• Automatic Transmission	70 N·m	51 lb ft
• Manual Transmission	70 N·m	51 lb ft
Generator Mounting Bolts and Nuts	23 N·m	17 lb ft
Heated Oxygen (HO2S1 and HO2S2) Sensor	45 N·m	33 lb ft
Ignition Coil Bolts	10 N·m	89 lb in
Intake Manifold Bolts and Nuts	25 N·m	19 lb ft
Intake Manifold Front Support Bracket Bolts	45 N·m	33 lb ft
Intake Manifold Top Support Bracket Bolts	15 N·m	11 lb ft
Lower Crankcase Bolts		
• First Pass	19 N·m	14 lb ft
• Second Pass (Final Torque)	27 N·m	20 lb ft
Main Bearing Cap Bolts:		
• First Pass	42 N·m	31 lb ft
• Second Pass (Final Torque)	60 N·m	44 lb ft
Negative Battery Cable	15 N·m	11 lb ft
Oil Filter Adapter	23 N·m	17 lb ft
Oil Pressure Switch	14 N·m	11 lb ft
Oil Pump Sprocket Cover Bolts	11 N·m	97 lb in
Oil Pump Bolts	27 N·m	20 lb ft
Oil Pump Case Bolts	12 N·m	106 lb in
Oil Pump Strainer Bolts	11 N·m	97 lb in
Oil Pump Relief Valve Retainer	29 N·m	21 lb ft
Power Steering Pump Bolts	25 N·m	19 lb ft
Spark Plugs	25 N·m	18 lb ft
Starter Bolts	30 N·m	22 lb ft
Strut Tower Brace	50 N·m	37 lb ft
Throttle Body Bolts and Nuts	25 N·m	19 lb ft
Timing Chain Cover Nut and Bolts	11 N·m	97 lb in
Timing Chain Tensioner Bolts (Camshaft)	11 N·m	97 lb in

Timing Chain Tensioner Bolts (Crankshaft)	11 N·m	97 lb in
Timing Chain Tensioner Nut (Camshaft)	45 N·m	33 lb ft
Timing Chain Tensioner Guide Bolts (Crankshaft)	9 N·m	62 lb in
Timing Chain Tensioner Shoe Nut (Crankshaft)	25 N·m	19 lb ft
Torque Converter Bolts	65 N·m	47 lb ft
Transmission Bracket Bolts	50 N·m	37 lb ft
Transmission to Engine Mounting Bolts	85 N·m	62 lb ft
Water Pump Bolts	27 N·m	20 lb ft

Engine Component Description – 2.0L

Engine Construction

The engine is a four cylinder in-line, four stroke gasoline unit with a Double Overhead Cam (DOHC) valve mechanism arranged for V-type valve configuration.

The DOHC is mounted over the cylinder head and is driven by the crankshaft through two timing chains. In this configuration there are no push rods and no rocker arms provided in the valve train system.

Cylinder Block

The cylinder block is an aluminum casting with four cast iron cylinder sleeves. The cylinder block has four in-line cylinders which are numbered 1 through 4 starting from the crankshaft pulley. The cylinder block contains coolant jackets through which coolant flows around the cylinders, to cool the cylinder block and maintain a constant operating temperature. The lower crankcase of the cylinder block is also an aluminum casting with cast iron inserts at the main bearing locations. The lower crankcase runs the entire perimeter of the cylinder block.

Crankshaft

The crankshaft is nodular cast iron and is supported by five main bearings. The crankpins of cylinders 1 and 4 are 180 degrees from the crankpins of cylinders 2 and 3. The crankshaft is counterbalanced by the flywheel, the crankshaft balancer and eight counterweights cast into the crankshaft. Oil holes run through the center of the crankshaft to supply oil to the connecting rods, bearings, pistons and other components. The end thrust load is taken by the thrust washers installed at the center number three bearing journal. The main bearings are of the precision insert type. The front of the crankshaft incorporates a sprocket which drives the oil pump through a sprocket and chain.

Connecting Rod and Piston

Each piston is cast aluminum alloy and has two compression rings and one oil ring. The piston rings are of a low tension type to reduce friction. The top compression ring is plated with chromium for abrasion resistance. The second compression ring is gray iron. The oil ring is a 3-piece spring construction, consisting of two rails and one spacer.

The piston pin is offset 0.5 mm (0.02 in) toward the thrust side. This allows a gradual change in thrust pressure against the cylinder wall as the piston travels through the bore. The connecting rods are forged steel, heat treated and shot peened. Piston pins are chromium steel and have a full floating fit in the pistons and in the connecting rods. The connecting rod bearings are of the precision insert type.

Oil Pump

The oil pump is bolted to the bottom of the lower crankcase. A sprocket on the front of the oil pump is driven by a chain from the sprocket on the front of the crankshaft. The tension on the oil pump drive chain is accomplished by an adjustable guide.

Oil Pan

The oil pan is constructed of stamped steel and is mounted to the lower crankcase. The oil pan includes a baffle that helps prevent the oil from shifting away from the oil pump suction pipe during hard turns, acceleration or stopping.

Cylinder Head

The cylinder head is an aluminum alloy casting with pressed-in valve guides and valve seat inserts. The fuel injection nozzles are located in the intake ports.

The cylinder head has four in-line combustion chambers. Each combustion chamber has two intake valves and two exhaust valves.

A fuel injector is positioned near each set of intake valves. During each intake stroke of the engine, a fuel injector sprays or atomizes fuel into a fine mist. This mist mixes with air drawn in through the intake manifold as the piston reaches the bottom of the cylinder during the intake stroke.

Valves

The valve train is driven by a double overhead camshaft. Each camshaft has eight cam lobes. Each cam lobe operates an intake or exhaust valve. Valve lash is not adjustable. Valve Lash is provided for by Hydraulic Valve Lash (HVL) Adjusters.

There are two intake and two exhaust valves per cylinder. There are two valve springs per valve. The valve springs are conical-shaped to fit inside the valve lifter body. Positive valve stem seals are used on all valves.

Valve Lifters

Direct acting hydraulic valve lifters are used. The valve lifter body includes a hardened iron contact foot bonded to a steel shell. These lifters are not repairable.

Valve Lifter (Hydraulic Valve Lash Adjuster) Operation

The Hydraulic Valve Lash (HVL) Adjuster located between the camshaft and the valve stem is a direct acting type.

With the engine oil delivered into it from the oil pump, the HVL adjuster operates as follows to adjust the valve lash (clearance) to 0 automatically at all times.

1. When the camshaft is not depressing the HVL adjuster, the adjuster is held against the camshaft and the valve stem by the plunger spring. In this state, the valve lash is kept at 0. (At 0 valve lash, the oil pressure becomes equal in the A and B chambers, and the check ball closes the passage between these two chambers.
2. When the lobe of the camshaft starts pressing the HVL adjuster, the adjuster and plunger are pushed downward at the same time the body is pushed upward by the counterforce from the valve stem. As a result, the B chamber is compressed and the pressure rises inside the HVL adjuster. The engine oil in the B chamber will leak through the slight clearance between the body and the plunger. However, since the compression time is very short, the volume of engine oil in the B chamber will only change slightly and the HVL adjuster (plunger and body as one unit) push down the valve stem to open the valve.
3. When the pushing of the camshaft against the HVL adjuster is over, the operation starts again as described in step 1. As the oil pressure in the B chamber is lower than that in A (the oil in the B chamber under high pressure has leaked gradually -- refer to step 2), the oil pressure in the A chamber pushes the check ball open to allow the engine oil to flow from the chamber to the B chamber until the oil pressure becomes equal between the two chambers.

Camshaft

Two camshafts are used, one for all intake valves, the other for all exhaust valves. The camshafts are cast iron. The exhaust camshaft rear end is slotted to mate with, and drive the camshaft position sensor.

Camshaft Housings and Caps

The camshaft housings and caps are cast aluminum. The camshafts run directly on the housings and caps without bearing inserts.

Camshaft Drive

Two roller timing chains are used. One chain is driven from the crankshaft and drives an idler gear. A second chain is driven from the idler gear and drives the camshafts.

A mechanical, ratcheting tensioner applies tension to an adjustable guide on the slack side of the crankshaft timing chain. A fixed guide controls crankshaft chain motion on the tension side of the chain.

An hydraulic tensioner and an upper guide control camshaft chain motion. The hydraulic tensioner incorporates a guide which applies tension to the slack side of the camshaft timing chain.

Timing Chain Housing and Cover

The timing chain housing is die cast aluminum and retains the crankshaft front seal.

Cylinder Head Cover

The cylinder head cover is die cast aluminum and houses the ignition coils.

Intake and Exhaust Manifold

The intake manifold is made of aluminum. The exhaust manifold is cast iron.

Engine Lubrication – 2.0L

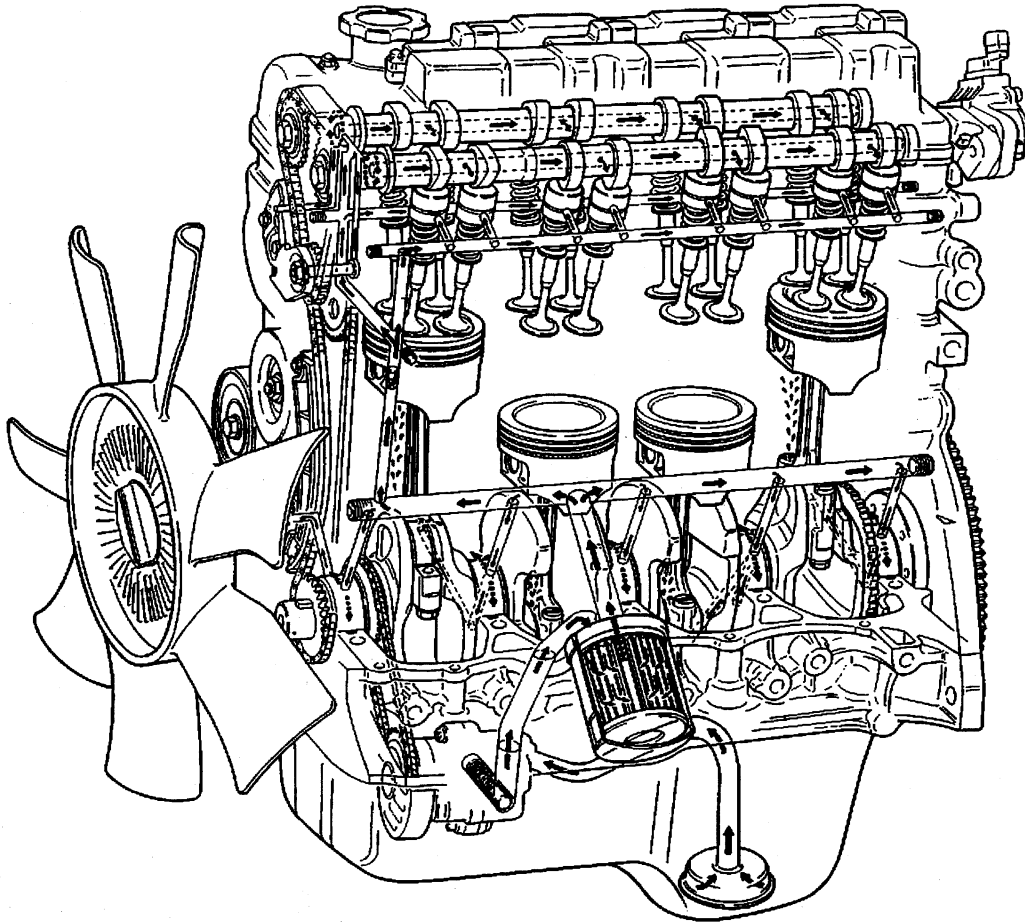

The lubrication system consists of an oil pan, oil pump screen, oil pump, oil filter and oil pressure regulator. This pressure-fed lubrication system supplies oil to the moving parts of the engine.

The oil pump is bolted to the bottom of the lower crankcase. A sprocket on the front of the oil pump is driven by a chain from the sprocket on the front of the crankshaft. The tension on the oil pump drive chain is accomplished by an adjustable guide.

The oil pump picks up oil from the oil pan and feeds it under pressure to the various parts of the engine. An oil strainer is mounted before the inlet to the oil pump to remove impurities which could clog or damage the oil pump or other engine components. The oil pump itself is a trochoid gear type pump with internal drive and driven gears. When the drive rotates, the driven gear rotates in the same direction, but on a different center point. This causes the space between the gears to constantly open and narrow, pulling oil in from the oil pan when the space opens and pumping the oil out to the engine as it narrows.

The oil filter is a full flow type with a relief valve built into the paper filter element. Contaminants which can get into the oil during operation could cause accelerated engine wear or seizing if allowed into the engine. The oil filter, situated at the beginning of the oil passage circuit, removes these contaminants as the oil passes through it. The relief valve spring will open under the pressure of the oil and allow oil to bypass the filter and flow directly to the engine.

At high engine speeds, the oil pump supplies a much higher amount of oil than required for lubrication of the engine. The oil pressure regulator prevents too much oil from entering the engine lubrication

passages. During normal oil supply, a coil spring and valve keeps the bypass closed, directing all oil pumped to the engine. When the amount of oil being pumped increases, the pressure becomes high enough (420 kPa (60 psi) to overcome the force of the spring, opening the valve and allowing excess oil to flow through the valve and drain back to the oil pan.

Oil is pumped from the oil pan by the oil pump. After it passes through the oil filter, it is fed through two paths to lubricate the cylinder block and cylinder head.

In one path, the oil is pumped through oil passages in the crankshaft to the connecting rods, then to the pistons and cylinders. It then drains back to the oil pan.

In the second path, the oil is pumped through the oil control valve, which consists of an orifice and a check ball, and then through passages to the camshaft and the hydraulic valve lash adjusters. The oil passes through internal passageways in the camshafts to lubricate the valve assemblies before draining back to the oil pan.

Engine Cooling

Engine Cooling System Approximate Capacities

Application	Specification	
	Metric	English
Cooling System Capacity 1.6 L Engine		
• Engine, Radiator and Heater Core	4.6 Liters	5.0 Quarts
• Coolant Recovery Reservoir	0.9 Liters	0.8 Quarts
• Total	5.5 Liters	5.8 Quarts
Cooling System Capacity 2.0 L Engine		
• Engine, Radiator and Heater Core	5.6 Liters	6.0 Quarts
• Coolant Recovery Reservoir	0.9 Liters	0.8 Quarts
• Total	6.5 Liters	6.8 Quarts
Coolant Solution Protection Point	-36°C	-33°F
Cooling System Pressure Capacity	90 kPa	13 psi
Generator/Coolant Pump Drive Belt Deflection	5-8 mm at 10 kg applied pressure	0.20-0.32 in at 22 lbs applied pressure
Radiator Cap Pressure Capacity	90 kPa	13 psi
Thermostat Valve Lift (Minimum)	8 mm at 95°C	0.31 in at 203°F
Thermostat Valve Opening Temperature	80-90°C	176-203°F

Fastener Tightening Specifications

Application	Specification	
	Metric	English
Air Conditioning (A/C) Flexible Hose Bolts	15 N·m	11 lb ft
Air Conditioning (A/C) Mounting Bracket Bolts	23 N·m	17 lb ft
Battery Cable-to-Battery Terminal Retainers	15 N·m	11 lb ft
Cooling Fan Nuts	11 N·m	97 lb in
Coolant Intake Pipe Bolt	11 N·m	97 lb in
Crankshaft Pulley Bolts	16 N·m	12 lb ft
Engine Oil Level Indicator Tube Mounting Bolt	11 N·m	97 lb in
Fan Clutch Nuts	11 N·m	97 lb in
Generator Mounting Bracket Bolt	23 N·m	17 lb ft
Generator Upper Mounting Bolt	27 N·m	20 lb ft
Heater Outlet Line Bolt	15 N·m	11 lb ft
Outlet Support Pipe Bolt	11 N·m	97 lb in
Power Steering Fluid Reservoir Bolts	15 N·m	11 lb ft
Radiator Bolts	10 N·m	89 lb in
Shroud Bolts	11 N·m	97 lb in
Thermostat Cap Bolts	16 N·m	12 lb ft
Water Pump Pulley Bolts	23 N·m	17 lb ft
Water Pump Nuts and Bolts	13 N·m	115 lb in

Cooling System Description and Operation

Coolant Heater – 2.0L Only

The engine coolant heater is used to preheat the engine coolant for cold weather starting. The engine coolant heater operates from a 110-volt AC power source and uses a heating element installed in the engine block coolant jacket. The heating element warms the coolant when the heater cord is plugged into an AC power source.

The unit has a detachable electrical cord. If the heater fails to operate, inspect the cord connections and power supply before replacing the heating element.

Cooling System

The cooling system's function is to maintain an efficient engine operating temperature during all engine speeds and operating conditions. The cooling system is designed to remove approximately one-third of the heat produced by the burning of the air-fuel mixture. When the engine is cold, the coolant does not flow to the radiator until the thermostat opens. This allows the engine to warm quickly.

Cooling Cycle

Coolant flows from the radiator outlet and into the water pump inlet. Some coolant flows from the water pump, to the heater core, then back to the water pump. This provides the passenger compartment with heat and defrost capability as the coolant warms up.

Coolant also flows from the water pump outlet and into the engine block. In the engine block, the coolant circulates through the water jackets surrounding the cylinders where it absorbs heat.

The coolant then flows through the cylinder head gasket openings and into the cylinder heads. In the cylinder heads, the coolant flows through the water jackets surrounding the combustion chambers and valve seats, where it absorbs additional heat.

From the cylinder heads, the coolant flows to the thermostat. The flow of coolant will either be stopped at the thermostat until the engine reaches normal operating temperature, or it will flow through the thermostat and into the radiator where it is cooled. At this point, the coolant flow cycle is completed.

Efficient operation of the cooling system requires proper functioning of all cooling system components. The cooling system consists of the following components:

Coolant

The engine coolant is a solution made up of a 50-50 mixture of DEX-COOL and suitable drinking water. The coolant solution carries excess heat away from the engine to the radiator, where the heat is dissipated to the atmosphere.

Radiator

The radiator is a heat exchanger. It consists of a core and two tanks. The aluminum core is a tube and fin crossflow design that extends from the inlet tank to the outlet tank. Fins are placed around the outside of the tubes to improve heat transfer to the atmosphere.

The inlet and outlet tanks are a molded, high temperature, nylon reinforced plastic material. A high temperature rubber gasket seals the tank flange edge to the aluminum core. The tanks are clamped to the core with clinch tabs. The tabs are part of the aluminum header at each end of the core.

The radiator also has a drain cock located in the bottom of the left hand tank. The drain cock unit includes the drain cock and drain cock seal.

The radiator removes heat from the coolant passing through it. The fins on the core transfer heat from the coolant passing through the tubes. As air passes between the fins, it absorbs heat and cools the coolant.

Pressure Cap

The pressure cap seals the cooling system. It contains a blow off or pressure valve and a vacuum or atmospheric valve. The pressure valve is held against its seat by a spring, which protects the radiator from excessive cooling system pressure. The vacuum valve is held against its seat by a spring, which permits opening of the valve to relieve vacuum created in the cooling system as it cools off. The vacuum, if not relieved, might cause the radiator and/or coolant hoses to collapse.

The pressure cap allows cooling system pressure to build up as the temperature increases. As the pressure builds, the boiling point of the coolant increases. Engine coolant can be safely run at a temperature much higher than the boiling point of the coolant at atmospheric pressure. The hotter the coolant is, the faster the heat transfers from the radiator to the cooler, passing air.

The pressure in the cooling system can get too high. When the cooling system pressure exceeds the rating of the pressure cap, it raises the pressure valve, venting the excess pressure.

As the engine cools down, the temperature of the coolant drops and a vacuum is created in the cooling system. This vacuum causes the vacuum valve to open, allowing outside air into the surge tank. This equalizes the pressure in the cooling system with atmospheric pressure, preventing the radiator and coolant hoses from collapsing.

Coolant Recovery System

The coolant recovery system consists of a plastic coolant recovery reservoir and overflow tube. The recovery reservoir is also called a recovery tank or expansion tank. It is partially filled with coolant and is connected to the radiator fill neck with the overflow tube. Coolant can flow back and forth between the radiator and the reservoir.

In effect, a cooling system with a coolant recovery reservoir is a closed system. When the pressure in the cooling system gets too high, it will open the pressure valve in the pressure cap. This allows the coolant, which has expanded due to being heated, is allowed to flow through the overflow tube and into the recovery reservoir. As the engine cools down, the temperature of the coolant drops and a vacuum is created in the cooling system. This vacuum opens the vacuum valve in the pressure cap, allowing some of the coolant in the reservoir to be siphoned back into the radiator. Under normal operating conditions, no coolant is lost. Although the coolant level in the recovery reservoir goes up and down, the radiator and cooling system are kept full. An advantage to using a coolant recovery reservoir is that it eliminates almost all air bubbles from the cooling system. Coolant without bubbles absorbs heat much better than coolant with bubbles.

Air Baffles and Seals

The cooling system uses deflectors, air baffles and air seals to increase cooling system capability. Deflectors are installed under the vehicle to redirect airflow beneath the vehicle and through the radiator to increase engine cooling. Air baffles are also used to direct airflow through the radiator and increase cooling capability. Air seals prevent air from bypassing the radiator and A/C condenser, and prevent recirculation of hot air for better hot weather cooling and A/C condenser performance.

Water Pump

The water pump is a centrifugal vane impeller type pump. The pump consists of a housing with coolant inlet and outlet passages and an impeller. The impeller is mounted on the pump shaft and consists of a series of flat or curved blades or vanes on a flat plate. When the impeller rotates, the coolant between the vanes is thrown outward by centrifugal force.

The impeller shaft is supported by one or more sealed bearings. The sealed bearings never need to be lubricated. Grease cannot leak out, dirt and water cannot get in as long as the seal is not damaged or worn.

The purpose of the water pump is to circulate coolant throughout the cooling system. The water pump is driven by the crankshaft via the drive belt.

Thermostat

The thermostat is a coolant flow control component. Its purpose is to help regulate the operating temperature of the engine. It utilizes a temperature sensitive wax-pellet element. The element connects to a valve through a small piston. When the element is heated, it expands and exerts pressure against the

small piston. This pressure forces the valve to open. As the element is cooled, it contracts. This contraction allows a spring to push the valve closed.

When the coolant temperature is below the rated thermostat opening temperature, the thermostat valve remains closed. This prevents circulation of the coolant to the radiator and allows the engine to warm up. After the coolant temperature reaches the rated thermostat opening temperature, the thermostat valve will open. The coolant is then allowed to circulate through the thermostat to the radiator where the engine heat is dissipated to the atmosphere. The thermostat also provides a restriction in the cooling system, after it has opened. This restriction creates a pressure difference which prevents cavitation at the water pump and forces coolant to circulate through the engine block.

Engine Electrical

Fastener General Specifications

Application	Specification	
	Metric	English
Battery Specifications:		
• Amphere Hour Capacity	36 and 48	
• Catalog Number	974 and 1904	
• Cold Cranking Amperes	390 and 550	
• Replacement Model	26R-50S	
• Reserve Capacity Minutes	71	
• Test Load Amperes	190 and 220	
Drive Belt Tension:		
• Drive Belt Deflection-New Belt	5-7 mm at 10 kg	0.20-0.27 in at 22 lbs
• Drive Belt Deflection-Used Belt	6-8 mm at 10 kg	0.24-0.31 in at 22 lbs
Ignition System:		
• Secondary Wire Resistance 1.6L	4K-10K ohms/m (1.2K-3.0K ohms/ft)	
• Spark Plug Gap	1.0-1.1 mm	0.039-0.043 in
Generator Specifications:		
• Brush Length--Standard	16 mm	0.63 in
• Brush Length--Minimum	2 mm	0.08 in
• Condenser Capacity	0.5 microfarads	
• Direction of Rotation	Clockwise (Viewed From Pulley Side)	
• Maximum Generator Output	60 and 70 amps	
• Maximum Generator Speed	18,000 RPM	
• Normal Operating Voltage	12 volts	
• Polarity Negative (-) Ground No-Load Generator Speed	1,300 RPM	
• Regular Voltage	14.4-15.0 volts	
• Rotor Slip Ring Resistance	2.5-2.9 ohms	
• Temperature Range	-30 to 90°C	-22 to 194°F
Starter Motor Specifications:		
• Brush Length--Standard 1.2kW	12.3 mm	0.44 in
• Brush Length--Minimum 1.2kW	7 mm	0.28 in
• Brush Length--Standard 1.4kW	16.5 mm	0.65 in
• Brush Length--Minimum 1.4kW	12.0 mm	0.47 in
• Commutator Run-Out--Standard	0.05 mm	0.002 in
• Commutator Run-Out--Maximum	0.40 mm	0.015 in
• Commutator Outside Diameter--Standard	29.4 mm	1.16 in
• Commutator Outside Diameter--Minimum	28.8 mm	1.13 in
• Commutator Insulation Depth--Standard	0.4-0.6 mm	0.015-0.023 in

• Commutator Insulation Depth--Minimum	0.2 mm	0.008 in
• Direction of Rotation	Clockwise (as viewed from pinion)	
• Number of Pinion Teeth	8	
• Output	1.2 and 1.4 kwatts	
• Rating	30 seconds	
• Solenoid Operating Voltage	8 volts maximum	
• Starter Motor Current Draw--No--Load-1.2 kW	90 Amps maximum at 11 Volts at 2500 RPM	
• Starter Motor Current Draw--No--Load--1.4 kW	90 amps max. at 11 volts at 3000 RPM	
• Starter Motor Current Draw--Load -1.2 kW (11 N·m / 97 lb in of torque 880 RPM)	300 amps at 7.5 volts	
• Starter Motor Current Draw--Load -1.4 kW (10 N·m / 89 lb in of torque 1000 RPM)	300 amps at 7.7 volts	
• Starter Motor Current Draw--Locked Rotor -1.2 kW (20 N·m / 14 lb ft of torque)	760 amps max. at 4 volts	
• Starter Motor Current Draw--Locked Rotor -1.4 kW (23 N·m / 17 lb ft of torque)	980 amps max. at 4 volts	
• Voltage	12 volts	

Fastener Tightening Specifications

Application	Specification	
	Metric	English
Battery Cable-to-Battery Terminal Retainers	15 N·m	11 lb ft
Battery Hold Down Bracket Nuts	8 N·m	71 lb in
Body Ground Bolt	8 N·m	71 lb in
Camshaft Position (CMP) Sensor Retaining Screws	15 N·m	11 lb ft
Commutator End Cover Bolts	8 N·m	71 lb in
Field Coil Lead Wire Retaining Nut	10 N·m	89 lb in
Generator B Terminal Nut	10 N·m	89 lb in
Generator Housing Bolts	17 N·m	10 lb ft
Generator Mounting Bolts	23 N·m	17 lb ft
Generator Pulley Nut	118 N·m	86 lb ft
Ignition Coil Bolts	10 N·m	89 lb in
Solenoid Mounting Screws	7 N·m	62 lb in
Spark Plugs	25 N·m	19 lb ft
Starter Motor Mounting Bolts	30 N·m	22 lb ft
Starter Solenoid Nut	8 N·m	71 lb in

Spark Plug Usage

Engine	Spark Plug Type	Spark Plug Gap
1.6L	Denso Type K20PR-U11	1.0-1.1 mm (0.039-0.043 in)
	NGK Type BKR6E-11	
2.0L	Denso Type SK16PR11 or PK16PR11	
	NGK Type IFR5G11 or PFR5G-11	

Replace the spark plugs every 100,000 km (60,000 mi) or 60 months.

Battery Description and Operation

Caution

Batteries produce explosive gases, contain corrosive acid, and supply levels of electrical current high enough to cause burns. Therefore, to reduce the risk of personal injury when working near a battery:

- Always shield your eyes and avoid leaning over the battery whenever possible.
- Do not expose the battery to open flames or sparks.
- Do not allow the battery electrolyte to contact the eyes or the skin. Flush immediately and thoroughly any contacted areas with water and get medical help.
- Follow each step of the jump starting procedure in order.
- Treat both the booster and the discharged batteries carefully when using the jumper cables.

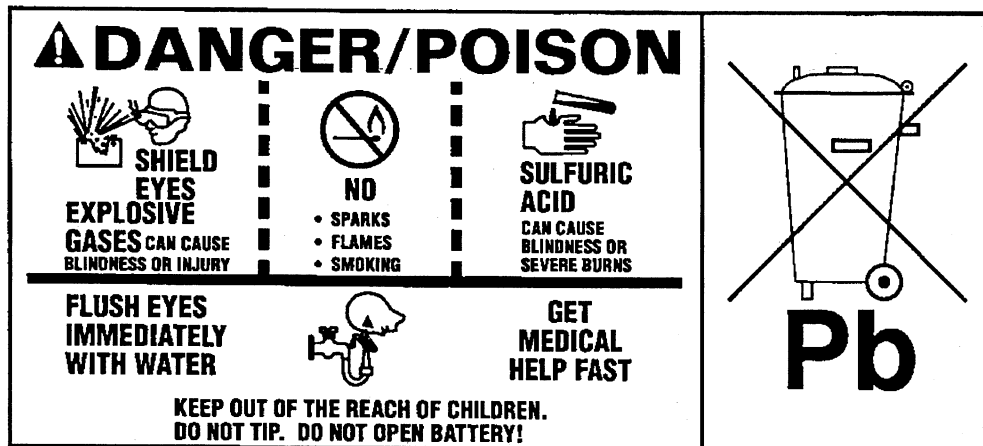

The maintenance free battery is standard. There are no vent plugs in the cover. The battery is completely sealed except for two small vent holes in the side. These vent holes allow the small amount of gas that is produced in the battery to escape.

The battery has three functions as a major source of energy:

- Engine cranking
- Voltage stabilizer
- Alternate source of energy with generator overload.

The battery specification label (example below) contains information about the following:

- The test ratings
- The original equipment catalog number
- The recommended replacement model number

CATALOG NO.

1819

CCA 770	LOAD TEST 380
REPLACEMENT MODEL 100 – 6YR	

A battery has 2 ratings:

- Reserve capacity
- Cold cranking amperage

When a battery is replaced use a battery with similar ratings. Refer to the battery specification label on the original battery or refer to Battery Usage .

Reserve Capacity

Reserve capacity is the amount of time in minutes it takes a fully charged battery, being discharged at a constant rate of 25 amperes and a constant temperature of 27°C (80°F) to reach a terminal voltage of 10.5 V. Refer to Battery Usage for the reserve capacity rating of the original equipment battery.

Cold Cranking Amperage

The cold cranking amperage is an indication of the ability of the battery to crank the engine at cold temperatures. The cold cranking amperage rating is the minimum amperage the battery must maintain for 30 seconds at -18°C (0°F) while maintaining at least 7.2 volts. Refer to Battery Usage for the cold cranking amperage rating for this vehicle.

Circuit Description

The battery positive terminal supplies Battery Positive voltage to the under hood fuse block and the rear fuse block. The under hood fuse block provides a cable connection for the generator and a cable connection for the starter.

The battery negative terminal is connected to chassis ground G305 and supplies ground for the AD converter in the DIM.

Starting System Description and Operation

The cranking circuit consists of the battery , the starter motor , the ignition switch and related parts. All of these components are connected electrically.

The starter solenoid windings are energized when the ignition switch is turned to the start position and the clutch pedal position (CPP) switch (manual transmission) or the transmission range switch (automatic

transmission) is closed. (In manual transmission equipped vehicles, the clutch pedal must be fully depressed to activate the clutch pedal position switch.) The resulting plunger and shift lever movement causes the drive pinion to engage the engine flywheel ring gear and the starter solenoid contacts to close.

With the contacts closed, the starter solenoid provides a closed circuit between the positive (+) battery terminal and the starter motor. The circuit is complete and cranking occurs as soon as the starter solenoid contacts are closed (the starter motor is permanently grounded to the engine block). When the engine starts, the clutch and drive assembly is designed to overrun and protect the armature from excessive speed until the ignition switch is released from the start position. After the ignition switch is released from the start position, a return spring in the solenoid assembly forces the starter solenoid contacts open, breaking the circuit between the battery and the starter motor, and disengaging the clutch and drive assembly. The ignition switch should be released immediately upon engine start-up to prevent prolonged overrun.

Charging System Description and Operation

All models utilize an internal regulator charging system. The integrated circuit (IC) regulator is a solid state unit that is mounted inside the generator to the rear end frame. All regulator components are enclosed in a solid mold to protect them from heat and corrosive elements.

The generator rotor bearings contain enough grease to eliminate the need for periodic lubrication. Two brushes carry current through two slip rings to the field coil mounted on the rotor. Stator windings are assembled inside a laminated core that form part of the generator drive end frame. A rectifier bridge that contains 6 diodes is connected to the stator windings. These diodes electrically change stator AC voltage into DC voltage. This DC voltage is then transmitted to the generator output terminal. Two neutral diodes are utilized to smooth out voltage fluctuations caused by varying generator speeds. A capacitor (condenser), mounted in the regulator, protects the rectifier bridge and neutral diodes. This capacitor also suppresses radio interference noise.

Engine Controls

Engine Controls – 1.6L

Fastener Tightening Specifications

Application	Specification	
	Metric	English
Accelerator Control Cable Adjusting Locknut for an A/T	23 N·m	17 lb ft
Air Cleaner Assembly Bolts	10 N·m	89 lb in
Battery Cables	8 N·m	72 lb in
Camshaft Position (CMP) Sensor Bolt	11 N·m	97 lb in
Camshaft Position (CMP) Sensor Housing Bolts	15 N·m	11 lb ft
Crankshaft Position (CKP) Sensor Bolt	6 N·m	54 lb in
ECT Sensor	15 N·m	11 lb ft
EGR Valve Pipe bolts	15 N·m	11 lb ft
EGR Valve Pipe Midway bolt	10 N·m	88 lb in
EGR Valve Bolts	25 N·m	18 lb ft
EVAP Canister Purge Valve Bracket Bolt	11 N·m	97 lb in
EVAP Canister Vent Solenoid Bracket Bolt	11 N·m	97 lb in
EVAP Canister Vent Valve Nut	1.6 N·m	14 lb in
EVAP Tank Pressure Control Solenoid Valve Nut	1.6 N·m	14 lb in
EVAP Tank Pressure Control Solenoid Valve Bracket Bolt	25 N·m	18 lb ft
Fuel Cut-Off Valve Screws	3.5 N·m	31.5 lb in
Fuel Filler Pipe Bolts	3.5 N·m	31.5 lb in
Fuel Filter Bracket Bolt	11 N·m	97 lb ft
Fuel Filter Bracket-to-Fuel Filter Bolt	11 N·m	97 lb ft
Fuel Pressure Regulator Bolts	10 N·m	89 lb in
Fuel Rail Bolts	23 N·m	17 lb ft
Fuel Rail Plug Bolt	30 N·m	22 lb ft
Fuel Pipes Bracket Hold Down Bolt	25 N·m	19 lb ft
Fuel Rail Reinforcement Bracket Bolt	25 N·m	19 lb lb
Fuel Sender (fuel pump) Assembly Bolts	5 N·m	45 lb in
Fuel Tank Pressure Sensor Bolts	3.5 N·m	31.5 lb in
Fuel Tank Shield (Protector) Bolts	35 N·m	26 lb ft
Fuel Tank Straps Bolts	50 N·m	36.5 lb ft
HO2S 1	45 N·m	32 lb ft
HO2S 2	45 N·m	32 lb ft
IAC Valve Screws	3.5 N·m	30 lb in
Ignition Coil Bolts	10 N·m	89 lb in
MAF Sensor Bolts	10 N·m	89 lb in
MAP Sensor Screws	3.5 N·m	30 lb in
Negative Battery Cable-to-Negative Battery Terminal Retainer	8.0 N·m	72 lb in
PCM Bracket Bolts	6 N·m	54 lb in
PSP Switch	27 N·m	20 lb ft
Spark Plugs	25 N·m	18 lb ft
Throttle Body Bolts and Nuts	25 N·m	18 lb ft
TP Sensor Bolts	3.5 N·m	30 lb in
Vehicle Speed Sensor (A/T) Bolt	6 N·m	54 lb in

Engine Controls – 2.0L

Fastener Tightening Specifications

Application	Specification	
	Metric	English
Accelerator Control Cable Adjusting Locknut	23 N·m	17 lb ft
Air Cleaner Assembly Bolts	10 N·m	89 lb in
Camshaft Position (CMP) Sensor Bolt	9 N·m	78 lb in
Camshaft Position (CMP) Sensor Housing Bolts	15 N·m	11 lb ft
Crankshaft Position (CKP) Sensor Bolt	6 N·m	54 lb in
ECT Sensor	15 N·m	11 lb ft
EGR Valve Pipe Bolts	15 N·m	11 lb ft
EGR Valve Pipe Midway Bolt	10 N·m	88 lb in
EGR Valve Bolts	25 N·m	18 lb ft
EVAP Canister Purge Valve Bracket Bolt	11 N·m	97 lb in
EVAP Canister Vent Solenoid Bracket Bolt	11 N·m	97 lb in
EVAP Tank Pressure Control Solenoid Valve Bracket Bolt	25 N·m	18 lb ft
Fuel Cut-Off Valve Screws	1.6 N·m	15 lb in
Fuel Filter Bracket Bolt	11 N·m	97 lb in
Fuel Filter Bracket-to-Fuel Filter Bolt	11 N·m	97 lb in
Fuel Pipe Guard Nuts	15 N·m	11 lb ft
Fuel Pressure Regulator Bolts	10 N·m	89 lb in
Fuel Rail Bolts	23 N·m	17 lb ft
Fuel Rail Plug Bolt	30 N·m	22 lb ft
Fuel Sender (fuel pump) Assembly Bolts	5 N·m	45 lb in
Fuel Tank Pressure Sensor Bolts	1.6 N·m	15 lb in
Fuel Tank Shield (Protector) Bolts	50 N·m	36 lb ft
Fuel Tank Straps Bolts	50 N·m	36 lb ft
HO2S 1	45 N·m	32 lb ft
HO2S 2	45 N·m	32 lb ft
IAC Valve Screws	3.5 N·m	30 lb in
Ignition Coil Bolts	10 N·m	89 lb in
MAP Sensor Screws	3.5 N·m	30 lb in
Negative Battery Cable-to-Negative Battery Terminal Retainer	8 N·m	72 lb in
PCM Bracket Bolts	6 N·m	54 lb in
PSP Switch	27 N·m	20 lb ft
Spark Plugs	25 N·m	18 lb ft
Throttle Body Bolts and Nuts	25 N·m	18 lb ft
TP Sensor Bolts	3.5 N·m	30 lb in
Vehicle Speed Sensor (A/T) Bolt	6 N·m	54 lb in

Fuel System Specifications – 1.6L and 2.0L

Use regular unleaded gasoline rated at 87 octane or higher. It is recommended that the gasoline meet specifications which have been developed by the American Automobile Manufacturers Association (AAMA) and endorsed by the Canadian Motor Vehicle Manufacturers Association for better vehicle performance and engine protection. Gasoline meeting the AAMA specification could provide improved driveability and emission control system performance compared to other gasolines. For more information, write to: American Automobile Manufacturer's Association, 7430 Second Ave, Suite 300, Detroit MI 48202.

Be sure the posted octane is at least 87. If the octane is less than 87, you may get a heavy knocking noise when you drive. If the knocking is bad enough, the knocking can damage your engine.

If you are using fuel rated at 87 octane or higher and you hear heavy knocking, your engine needs service. But do not worry if you hear a little pinging noise when you are accelerating or driving up a hill. That is normal, and you do not have to buy a higher octane fuel to get rid of the pinging. However, if there is a heavy, constant knock, that means you have a problem.

Notice

Your vehicle was not designed for fuel that contains methanol. Do not use methanol fuel which can corrode metal parts in your fuel system and also damage plastic and rubber parts. This kind of damage would not be covered under your warranty.

If your vehicle is certified to meet California Emission Standards, indicated on the under hood emission control label, your vehicle is designed to operate on fuels that meet California specifications. If such fuels are not available in states adopting California emissions standards, your vehicle will operate satisfactorily on fuels meeting federal specifications, but emission control system performance may be affected. The malfunction indicator lamp on your instrument panel may turn ON and/or your vehicle may fail a smog-check test. If this occurs, return to your authorized dealer for diagnosis to determine the cause of failure. In the event there is a determination that the cause of the condition is the type of fuels used, repairs may not be covered by your warranty.

Some gasolines that are not reformulated for low emissions may contain an octane-enhancing additive called methylcyclopentadienyl manganese tricarbonyl (MMT). Ask your service station operator whether or not the fuel contains MMT.

Exhaust System

Fastener Tightening Specifications

Application	Specification	
	Metric	English
Catalytic Converter Assembly-to-Resonator/Muffler/Tail Pipe Nuts	35 N·m	26 lb ft
Front Pipe-to-Catalytic Converter Assembly Bolts	50 N·m	37 lb ft
Front Pipe-to-Exhaust Manifold Bolts	50 N·m	37 lb ft
Hanger Bolts	15 N·m	11 lb ft
PUP Catalytic Converter-to-Exhaust Manifold Nuts	50 N·m	37 lb ft
PUP Catalytic Converter-to-Standard Catalytic Converter Assembly Bolts	50 N·m	37 lb ft

Exhaust System Description

Periodic maintenance of the exhaust system is not required; however, if the vehicle is raised for other service, check the general condition of the following components:

- The Three-Way Catalytic Converter (TWC)
- The pipes
- The muffler

Check the complete exhaust system and nearby body areas for the following, which could permit exhaust fumes to seep into the passenger compartment:

- Broken parts
- Damaged parts
- Missing parts
- Mispositioned parts
- Open seams
- Holes
- Loose connections
- Other deterioration Dust or water in the rear compartment may indicate a problem in one of these areas. Any faulty areas should be corrected immediately.

The exhaust system consists (from front to rear) of the following components:

- The exhaust manifold
- The Warm-Up Three-Way Catalytic Converter (WU-TWC), if equipped
- The exhaust manifold heat shield
- The front pipe/TWC assembly
- The resonator/muffler/tail pipe assembly

Various flexible rubber hangers suspend the system along the underside of the vehicle.

Transmission/Transaxle Description and Operation

Manual Transmission Specifications

Application	Specification	
	Metric	English
2-Wheel Drive	1.9 l	2.0 qt
4-Wheel Drive	1.5 l	1.6 qt
Oil Recommended	75W-90 GL4 Lubricant or equivalent	

Fastener Tightening Specifications

Application	Specification	
	Metric	English
Backup Lamp Switch	23 N·m	17 lb ft
Clutch Release Lever Bolt and Nut	24 N·m	17 lb ft
Extension Case Bolts	28 N·m	20 lb ft
Fan Shroud Bolt	10 N·m	89 lb in
Flywheel Inspection Cover Bolt	10 N·m	89 lb in
Front Skid Plate Bolt	54 N·m	40 lb ft
Gearshift Control Lever Lower Boot Plate Bolt	7 N·m	62 lb in
Gearshift Lever Case Bolt	17 N·m	12 lb ft
Left Transmission-to-Engine Reinforcement Brace Bolt	100 N·m	72 lb ft
Lever Locating Bolt	20 N·m	15 lb ft
Lower Transmission-to-Engine Nut	100 N·m	72 lb ft
Rear Case Bolt (Four-Wheel Drive Models)	28 N·m	20 lb ft
Rear Propeller Shaft Bolt and Nut (Two-Wheel Drive Models)	50 N·m	37 lb ft
Rear Transmission Crossmember Bolt (Two-Wheel Drive Models)	60 N·m	44 lb ft
Rear Transmission Mount Bolt (Two-Wheel Drive Models)	60 N·m	44 lb ft
Reverse Gearshift Limit Bolt	35 N·m	26 lb ft
Right Transmission-to-Engine Reinforcement Brace Bolt	100 N·m	72 lb ft
Select Return Spring Bolt	32 N·m	24 lb ft
Speedometer Driven Gear Case Bolt	12 N·m	106 lb in
Starter Motor Bolts and Nut	30 N·m	22 lb ft
Transmission Drain Plug	28 N·m	20 lb ft
Transmission Oil Lever/Filler Plug	28 N·m	20 lb ft
Upper Transmission-to-Engine Bolt	100 N·m	72 lb ft

Automatic Transmission - 4 Speed-M41

Fastener Tightening Specifications

Application	Specification	
	Metric	English
Brake Applying Cover Bolts	10 N·m	89 lb in
Cooler Pipe Clamp Bolt	23 N·m	17 lb ft
Cooler Pipe Flare Nuts	25 N·m	18 lb ft
Fluid Filler Tube Bracket Bolt	23 N·m	17 lb ft
Fluid Filter Screen Bolts	5 N·m	44 lb in
Flywheel Inspection Cover Bolts	10 N·m	89 lb in
Flywheel-to-Torque Converter Bolts	65 N·m	48 lb ft
Front Propeller Shaft Bolts and Nuts (Four-Wheel Drive Models)	50 N·m	37 lb ft
Front Skid Plate Bolts	54 N·m	40 lb ft
Left and Right Case Stiffener Bolts	60 N·m	44 lb ft
Lower Transmission Retaining Nuts	85 N·m	62 lb ft
Manual Selector Bolts	18 N·m	13 lb ft
Manual Shaft Lever Nut	13 N·m	115 lb in
Rear Propeller Shaft Bolts and Nuts	50 N·m	37 lb ft
Shift Select Cable Locknut	7 N·m	62 lb in
Shift Solenoid Assembly Bolts	10 N·m	89 lb ft
TCC Control Valve Plate Bolts	5 N·m	44 lb in
Torque Stopper Bushing Bolts (Four-Wheel Drive Models)	50 N·m	37 lb ft
Transfer Adapter Case Bolts	31 N·m	23 lb ft
Transmission Fluid Drain Plug	17 N·m	13 lb ft
Transmission Fluid Pan Bolts	5 N·m	44 lb in
Transmission Range Switch Bolt	5 N·m	44 lb in
Transmission Range Switch Set Nut	5 N·m	44 lb in
Upper Transmission Retaining Bolts	85 N·m	62 lb ft

Transmission General Information

This automatic is a full automatic type with three speeds plus overdrive. The torque converter is a three element, one step and two phase type and is equipped with an electronically controlled lock up mechanism. The internal drive components consist of 3 sets of planetary gear units. 3 disc type clutches, 4 disc type brakes and 3 one-way clutches.

Automatic Transmission Shift Lock Control Description

The automatic transmission shift lock control system prevents the driver from shifting out of Park without depressing the brake pedal. The shift lock control solenoid is provided battery voltage when the ignition is in the ON position and the vehicle is in Park. The shift lock control solenoid is mounted near the floor shifter in the front floor console, and mechanically locks the shifter from moving. When pressure is applied to the brake pedal, the shift lock control solenoid is energized and releases the locking tab on the floor shifter.

Clutch

Fastener Tightening Specifications

Application	Specification	
	Metric	English
Clutch Actuator Cylinder Bolts	16 N·m	11.5 lb ft
Clutch Actuator Cylinder Line Bolts	23 N·m	17 lb ft
Clutch Fluid Pipe Flare Nuts	13 N·m	10 lb ft
Clutch Master Cylinder Bolt and Nut	13 N·m	115 lb in
Clutch Pedal Bracket Bolts and Nuts	33 N·m	24 lb ft
Clutch Pedal Position (CPP) Switch Locknut	13 N·m	115 lb in
Clutch Pedal Shaft Arm Bolt and Nut	24 N·m	17 lb ft
Pressure Plate Cover Bolt	23 N·m	17 lb ft

Clutch Operating Members

The operating members control clutch engagement/disengagement and are known as the clutch release system. The clutch release system consists of:

- The clutch release bearing
- The clutch release fork
- The clutch pedal shaft arm
- The clutch pedal

Hydraulic Clutch Description

The clutch is a diaphragm-spring clutch of a dry single disc type. The diaphragm spring is of a tapering-finger type, which is a solid ring in the outer diameter part, with a series of tapered fingers pointing inward. The disc, carrying torsional coil springs, is positioned on the transmission input shaft with an involute spline fit.

The clutch cover is secured to the flywheel, and carries the diaphragm spring in such a way that the peripheral edge part of the spring pushes on the pressure plate against the flywheel with the disc in between, when the clutch release bearing is held back. This is the engaged condition of the clutch.

With the clutch pedal depressed, the clutch master cylinder becomes pressurized from the force of the push rod into the master cylinder. This forces hydraulic fluid into the hydraulic line to the actuator cylinder. The actuator cylinder then pushes the release fork to engage the release bearing to advance and push on the tips of the tapered fingers of the diaphragm spring. When this happens, the diaphragm spring pulls the pressure plate away from the flywheel, thereby interrupting the flow of drive from the flywheel through the clutch disc to transmission input shaft.

**This page
intentionally left
blank.**

Abbreviations and Meanings

Abbreviation	Meaning
A	
A	Ampere(s)
ABS	Antilock Brake System
A/C	Air Conditioning
AC	Alternating Current
ACC	Accessory, Automatic Climate Control
ACL	Air Cleaner
ACR4	Air Conditioning Refrigerant, Recovery, Recycling, Recharging
AD	Automatic Disconnect
A/D	Analog to Digital
ADL	Automatic Door Lock
A/F	Air/Fuel Ratio
AH	Active Handling
AIR	Secondary Air Injection
ALC	Automatic Level Control, Automatic Lamp Control
AM/FM	Amplitude Modulation/Frequency Modulation
Ant	Antenna
AP	Accelerator Pedal
APCM	Accessory Power Control Module
API	American Petroleum Institute
APP	Accelerator Pedal Position
APT	Adjustable Part Throttle
ASM	Assembly, Accelerator and Servo Control Module
ASR	Acceleration Slip Regulation
A/T	Automatic Transmission/Transaxle
ATC	Automatic Transfer Case, Automatic Temperature Control
ATDC	After Top Dead Center
ATSLC	Automatic Transmission Shift Lock Control
Auto	Automatic
avg	Average
A4WD	Automatic Four-Wheel Drive
AWG	American Wire Gage
B	
B+	Battery Positive Voltage
BARO	Barometric Pressure
BATT	Battery
BBV	Brake Booster Vacuum
BCA	Bias Control Assembly
BCM	Body Control Module

BHP	Brake Horsepower
BLK	Black
BLU	Blue
BP	Back Pressure
BPCM	Battery Pack Control Module
BPMV	Brake Pressure Modulator Valve
BPP	Brake Pedal Position
BRN	Brown
BTDC	Before Top Dead Center
BTM	Battery Thermal Module
BTSI	Brake Transmission Shift Interlock
Btu	British Thermal Units
C	
°C	Degrees Celsius
CAC	Charge Air Cooler
CAFE	Corporate Average Fuel Economy
Cal	Calibration
Cam	Camshaft
CARB	California Air Resources Board
CC	Coast Clutch
cm ³	Cubic Centimeters
CCM	Convenience Charge Module, Chassis Control Module
CCOT	Cycling Clutch Orifice Tube
CCP	Climate Control Panel
CD	Compact Disc
CE	Commutator End
CEAB	Cold Engine Air Bleed
CEMF	Counter Electromotive Force
CEX	Cabin Exchanger
cfm	Cubic Feet per Minute
cg	Center of Gravity
CID	Cubic Inch Displacement
CKP	Crankshaft Position
CKT	Circuit
C/Ltr	Cigar Lighter
CL	Closed Loop
CLS	Coolant Level Switch
CMC	Compressor Motor Controller
CMP	Camshaft Position
CNG	Compressed Natural Gas
CO	Carbon Monoxide
CO2	Carbon Dioxide

Coax	Coaxial
COMM	Communication
Conn	Connector
CPA	Connector Position Assurance
CPP	Clutch Pedal Position
CPS	Central Power Supply
CPU	Central Processing Unit
CRT	Cathode Ray Tube
CRTC	Cathode Ray Tube Controller
CS	Charging System
CSFI	Central Sequential Fuel Injection
CTP	Closed Throttle Position
cu ft	Cubic Foot/Feet
cu in	Cubic Inch/Inches
CV	Constant Velocity Joint
CVRSS	Continuously Variable Road Sensing Suspension
Cyl	Cylinder(s)
D	
DAB	Delayed Accessory Bus
dB	Decibels
dBA	Decibels on A-weighted Scale
DC	Direct Current, Duty Cycle
DCM	Door Control Module
DE	Drive End
DEC	Digital Electronic Controller
DERM	Diagnostic Energy Reserve Module
DI	Distributor Ignition
dia	Diameter
DIC	Driver Information Center
Diff	Differential
DIM	Dash Integration Module
DK	Dark
DLC	Data Link Connector
DMCM	Drive Motor Control Module
DMM	Digital Multimeter
DMSDS	Drive Motor Speed and Direction Sensor
DMU	Drive Motor Unit
DOHC	Dual Overhead Camshafts
DR, Drvr	Driver
DRL	Daytime Running Lamps
DTC	Diagnostic Trouble Code

E	
EBCM	Electronic Brake Control Module
EBTCM	Electronic Brake and Traction Control Module
EC	Electrical Center, Engine Control
ECC	Electronic Climate Control
ECI	Extended Compressor at Idle
ECL	Engine Coolant Level
ECM	Engine Control Module, Electronic Control Module
ECS	Emission Control System
ECT	Engine Coolant Temperature
EEPROM	Electrically Erasable Programmable Read Only Memory
EEVIR	Evaporator Equalized Values in Receiver
EFE	Early Fuel Evaporation
EGR	Exhaust Gas Recirculation
EGR TVV	Exhaust Gas Recirculation Thermal Vacuum Valve
EHPS	Electro-Hydraulic Power Steering
EI	Electronic Ignition
ELAP	Elapsed
ELC	Electronic Level Control
E/M	English/Metric
EMF	Electromotive Force
EMI	Electromagnetic Interference
Eng	Engine
EOP	Engine Oil Pressure
EOT	Engine Oil Temperature
EPA	Environmental Protection Agency
EPR	Exhaust Pressure Regulator
EPROM	Erasable Programmable Read Only Memory
ESB	Expansion Spring Brake
ESC	Electronic Suspension Control
ESD	Electrostatic Discharge
ESN	Electronic Serial Number
ETC	Electronic Throttle Control, Electronic Temperature Control, Electronic Timing Control
ETCC	Electronic Touch Climate Control
ETR	Electronically Tuned Receiver
ETS	Enhanced Traction System
EVAP	Evaporative Emission
EVO	Electronic Variable Orifice
Exh	Exhaust

F	
°F	Degrees Fahrenheit
FC	Fan Control
FDC	Fuel Data Center
FED	Federal All United States except California
FEDS	Fuel Enable Data Stream
FEX	Front Exchanger
FF	Flexible Fuel
FFH	Fuel-Fired Heater
FI	Fuel Injection
FMVSS	Federal U.S. Motor Vehicle Safety Standards
FP	Fuel Pump
ft	Foot/Feet
FT	Fuel Trim
F4WD	Full Time Four-Wheel Drive
4WAL	Four-Wheel Antilock
4WD	Four-Wheel Drive
FW	Flat Wire
FWD	Front Wheel Drive, Forward
G	
g	Grams, Gravitational Acceleration
GA	Gage, Gauge
gal	Gallon
gas	Gasoline
GCW	Gross Combination Weight
Gen	Generator
GL	Gear Lubricant
GM	General Motors
GM SPO	General Motors Service Parts Operations
gnd	Ground
gpm	Gallons per Minute
GRN	Green
GRY	Gray
GVWR	Gross Vehicle Weight Rating
H	
H	Hydrogen
H ₂ O	Water
Harn	Harness
HC	Hydrocarbons
H/CMPR	High Compression

HD	Heavy Duty
HDC	Heavy Duty Cooling
hex	Hexagon, Hexadecimal
Hg	Mercury
Hi Alt	High Altitude
HO2S	Heated Oxygen Sensor
hp	Horsepower
HPL	High Pressure Liquid
HPS	High Performance System
HPV	High Pressure Vapor
HPVS	Heat Pump Ventilation System
Htd	Heated
HTR	Heater
HUD	Head-up Display
HVAC	Heater-Ventilation-Air Conditioning
HVACM	Heater-Vent-Air Conditioning Module
HVIL	High Voltage Interlock Loop
HVM	Heater Vent Module
Hz	Hertz
I	
IAC	Idle Air Control
IAT	Intake Air Temperature
IC	Integrated Circuit, Ignition Control
ICCS	Integrated Chassis Control System
ICM	Ignition Control Module
ID	Identification, Inside Diameter
IDI	Integrated Direct Ignition
IGBT	Insulated Gate Bi-Polar Transistor
ign	Ignition
ILC	Idle Load Compensator
in	Inch/Inches
INJ	Injection
inst	Instantaneous, Instant
IP	Instrument Panel
IPC	Instrument Panel Cluster
IPM	Instrument Panel Module
I/PEC	Instrument Panel Electrical Center
ISC	Idle Speed Control
ISO	International Standards Organization
ISS	Input Speed Shaft, Input Shaft Speed

K	
KAM	Keep Alive Memory
KDD	Keyboard Display Driver
kg	Kilogram
kHz	Kilohertz
km	Kilometer
km/h	Kilometers per Hour
km/l	Kilometers per Liter
kPa	Kilopascals
KS	Knock Sensor
kV	Kilovolts
L	
L	Liter
L4	Four Cylinder Engine, In-Line
L6	Six-Cylinder Engine, In-Line
lb	Pound
lb ft	Pound Feet Torque
lb in	Pound Inch Torque
LCD	Liquid Crystal Display
LDCL	Left Door Closed Locking
LDCM	Left Door Control Module
LDM	Lamp Driver Module
LED	Light Emitting Diode
LEV	Low Emissions Vehicle
LF	Left Front
lm	Lumens
LR	Left Rear
LT	Left
LT	Light
LT	Long Term
LTPI	Low Tire Pressure Indicator
LTPWS	Low Tire Pressure Warning System
M	
MAF	Mass Air Flow
Man	Manual
MAP	Manifold Absolute Pressure
MAT	Manifold Absolute Temperature
max	Maximum
M/C	Mixture Control
MDP	Manifold Differential Pressure

MFI	Multiport Fuel Injection
mi	Miles
MIL	Malfunction Indicator Lamp
min	Minimum
MIN	Mobile Identification Number
mL	Milliliter
mm	Millimeter
mpg	Miles per Gallon
mph	Miles per Hour
ms	Millisecond
MST	Manifold Surface Temperature
MSVA	Magnetic Steering Variable Assist, Magnasteer®
M/T	Manual Transmission/Transaxle
MV	Megavolt
mV	Millivolt
N	
NAES	North American Export Sales
NC	Normally Closed
NEG	Negative
Neu	Neutral
NI	Neutral Idle
NiMH	Nickel Metal Hydride
NLGI	National Lubricating Grease Institute
N·m	Newton-meter Torque
NO	Normally Open
NOx	Oxides of Nitrogen
NPTC	National Pipe Thread Coarse
NPTF	National Pipe Thread Fine
NOVRAM	Non-Volatile Random Access Memory
O	
O ₂	Oxygen
O ₂ S	Oxygen Sensor
OBD	On-Board Diagnostics
OBD II	On-Board Diagnostics Second Generation
OC	Oxidation Converter Catalytic
OCS	Opportunity Charge Station
OD	Outside Diameter
ODM	Output Drive Module
ODO	Odometer
OE	Original Equipment
OEM	Original Equipment Manufacturer
OHC	Overhead Camshaft

ohms	Ohm
OL	Open Loop, Out of Limits
ORC	Oxidation Reduction Converter Catalytic
ORN	Orange
ORVR	On-Board Refueling Vapor Recovery
OSS	Output Shaft Speed
oz	Ounce(s)
P	
PAG	Polyalkylene Glycol
PAIR	Pulsed Secondary Air Injection
PASS, PSGR	Passenger
PASS-Key®	Personalized Automotive Security System
P/B	Power Brakes
PC	Pressure Control
PCB	Printed Circuit Board
PCM	Powertrain Control Module
PCS	Pressure Control Solenoid
PCV	Positive Crankcase Ventilation
PEB	Power Electronics Bay
PID	Parameter Identification
PIM	Power Inverter Module
PM	Permanent Magnet Generator
P/N	Part Number
PNK	Pink
PNP	Park/Neutral Position
PRNDL	Park, Reverse, Neutral, Drive, Low
POA	Pilot Operated Absolute Valve
POS	Positive, Position
POT	Potentiometer Variable Resistor
PPL	Purple
ppm	Parts per Million
PROM	Programmable Read Only Memory
P/S, PS	Power Steering
PSCM	Power Steering Control Module, Passenger Seat Control Module
PSD	Power Sliding Door
PSP	Power Steering Pressure
psi	Pounds per Square Inch
psia	Pounds per Square Inch Absolute
psig	Pounds per Square Inch Gauge
pt	Pint
PTC	Positive Temperature Coefficient
PWM	Pulse Width Modulated

Q	
QDM	Quad Driver Module
qt	Quart(s)
R	
R-12	Refrigerant-12
R-134a	Refrigerant-134a
RAM	Random Access Memory, Non-permanent memory device, memory contents are lost when power is removed.
RAP	Retained Accessory Power
RAV	Remote Activation Verification
RCDLR	Remote Control Door Lock Receiver
RDCM	Right Door Control Module
Ref	Reference
Rev	Reverse
REX	Rear Exchanger
RIM	Rear Integration Module
RF	Right Front, Radio Frequency
RFA	Remote Function Actuation
RFI	Radio Frequency Interference
RH	Right Hand
RKE	Remote Keyless Entry
Rly	Relay
ROM	Read Only Memory, Permanent memory device, memory contents are retained when power is removed.
RPM	Revolutions per Minute Engine Speed
RPO	Regular Production Option
RR	Right Rear
RSS	Road Sensing Suspension
RTD	Real Time Damping
RT	Right
RTV	Room Temperature Vulcanizing Sealer
RWAL	Rear Wheel Antilock
RWD	Rear Wheel Drive
S	
s	Second(s)
SAE	Society of Automotive Engineers
SC	Supercharger
SCB	Supercharger Bypass
SCM	Seat Control Module
SDM	Sensing and Diagnostic Module
SEO	Special Equipment Option
SFI	Sequential Multiport Fuel Injection

SI	System International Modern Version of Metric System
SIAB	Side Impact Air Bag
SIR	Supplemental Inflatable Restraint
SLA	Short/Long Arm Suspension
sol	Solenoid
SO2	Sulfur Dioxide
SP	Splice Pack
S/P	Series/Parallel
SPO	Service Parts Operations
SPS	Service Programming System, Speed Signal
sq ft, ft ²	Square Foot/Feet
sq in, in ²	Square Inch/Inches
SRC	Service Ride Control
SRI	Service Reminder Indicator
SRS	Supplemental Restraint System
SS	Shift Solenoid
ST	Scan Tool
STID	Station Identification Station ID
S4WD	Selectable Four-Wheel Drive
Sw	Switch
SWPS	Steering Wheel Position Sensor
syn	Synchronizer
T	
TAC	Throttle Actuator Control
Tach	Tachometer
TAP	Transmission Adaptive Pressure, Throttle Adaptive Pressure
TBI	Throttle Body Fuel Injection
TC	Turbocharger, Transmission Control
TCC	Torque Converter Clutch
TCS	Traction Control System
TDC	Top Dead Center
TEMP	Temperature
Term	Terminal
TFP	Transmission Fluid Pressure
TFT	Transmission Fluid Temperature
THM	Turbo Hydro-Matic
TIM	Tire Inflation Monitoring, Tire Inflation Module
TOC	Transmission Oil Cooler
TP	Throttle Position
TPA	Terminal Positive Assurance
TPM	Tire Pressure Monitoring, Tire Pressure Monitor
TR	Transmission Range

TRANS	Transmission/Transaxle
TT	Tell Tail Warning Lamp
TV	Throttle Valve
TVRS	Television and Radio Suppression
TVV	Thermal Vacuum Valve
TWC	Three Way Converter Catalytic
TWC+OC	Three Way + Oxidation Converter Catalytic
TXV	Thermal Expansion Valve
U	
UART	Universal Asynchronous Receiver Transmitter
U/H	Underhood
U/HEC	Underhood Electrical Center
U-joint	Universal Joint
UTD	Universal Theft Deterrent
UV	Ultraviolet
V	
V	Volt(s), Voltage
V6	Six-Cylinder Engine, V-Type
V8	Eight-Cylinder Engine, V-Type
Vac	Vacuum
VAC	Vehicle Access Code
VATS	Vehicle Anti-Theft System
VCIM	Vehicle Communication Interface Mode
VCM	Vehicle Control Module
V dif	Voltage Difference
VDOT	Variable Displacement Orifice Tube
VDV	Vacuum Delay Valve
vel	Velocity
VES	Variable Effort Steering
VF	Vacuum Fluorescent
VIO	Violet
VIN	Vehicle Identification Number
VLR	Voltage Loop Reserve
VMV	Vacuum Modulator Valve
VR	Voltage Regulator
V ref	Voltage Reference
VSES	Vehicle Stability Enhancement System
VSS	Vehicle Speed Sensor

W	
w/	With
W/B	Wheel Base
WHL	Wheel
WHT	White
w/o	Without
WOT	Wide Open Throttle
W/P	Water Pump
W/S	Windshield
WSS	Wheel Speed Sensor
WU-OC	Warm Up Oxidation Converter Catalytic
WU-TWC	Warm Up Three-Way Converter Catalytic
X	
X-valve	Expansion Valve
Y	
yd	Yard(s)
YEL	Yellow

**This page
intentionally left
blank.**

Conversion - English/Metric

English	Multiply/ Divide by	Metric
In order to calculate English measurement, divide by the number in the center column.		
In order to calculate metric measurement, multiply by the number in the center column.		
Length		
in	25.4	mm
ft	0.3048	m
yd	0.9144	
mi	1.609	km
Area		
sq in	645.2	sq mm
	6.45	sq cm
sq ft	0.0929	sq m
sq yd	0.8361	
Volume		
cu in	16,387.00	cu mm
	16.387	cu cm
	0.0164	L
qt	0.9464	
gal	3.7854	
cu yd	0.764	cu m
Mass		
lb	0.4536	kg
ton	907.18	
	0.907	tonne (t)
Force		
Kg F	9.807	newtons (N)
oz F	0.278	
lb F	4.448	
Acceleration		
ft/s ²	0.3048	m/s ²
in/s ²	0.0254	
Torque		
Lb in	0.11298	N·m
lb ft	1.3558	
Power		
hp	0.745	kW

Pressure (Stress)		
inches of H2O	0.2488	kPa
lb/sq in	6.895	
Energy (Work)		
Btu	1055	J (J= one Ws)
lb ft	1.3558	
kW hour	3,600,000.00	
Light		
Foot Candle	10.764	lm/m ²
Velocity		
mph	1.6093	km/h
Temperature		
(°F - 32) 5/9	=	°C
°F	=	(9/5 °C + 32)
Fuel Performance		
235.215/mpg	=	100 km/L

Equivalents - Decimal and Metric

Fraction (in)	Decimal (in)	Metric (mm)
1/64	0.015625	0.39688
1/32	0.03125	0.79375
3/64	0.046875	1.19062
1/16	0.0625	1.5875
5/64	0.078125	1.98437
3/32	0.09375	2.38125
7/64	0.109375	2.77812
1/8	0.125	3.175
9/64	0.140625	3.57187
5/32	0.15625	3.96875
11/64	0.171875	4.36562
3/16	0.1875	4.7625
13/64	0.203125	5.15937
7/32	0.21875	5.55625
15/64	0.234375	5.95312
1/4	0.25	6.35
17/64	0.265625	6.74687
9/32	0.28125	7.14375
19/64	0.296875	7.54062
5/16	0.3125	7.9375
21/64	0.328125	8.33437
11/32	0.34375	8.73125
23/64	0.359375	9.12812
3/8	0.375	9.525
25/64	0.390625	9.92187
13/32	0.40625	10.31875
27/64	0.421875	10.71562
7/16	0.4375	11.1125
29/64	0.453125	11.50937
15/32	0.46875	11.90625
31/64	0.484375	12.30312
1/2	0.5	12.7
33/64	0.515625	13.09687
17/32	0.53125	13.49375
35/64	0.546875	13.89062
9/16	0.5625	14.2875
37/64	0.578125	14.68437
19/32	0.59375	15.08125
39/64	0.609375	15.47812

Fraction (in)	Decimal (in)	Metric (mm)
5/8	0.625	15.875
41/64	0.640625	16.27187
21/32	0.65625	16.66875
43/64	0.671875	17.06562
11/16	0.6875	17.4625
45/64	0.703125	17.85937
23/32	0.71875	18.25625
47/64	0.734375	18.65312
3/4	0.75	19.05
49/64	0.765625	19.44687
25/32	0.78125	19.84375
51/64	0.796875	20.24062
13/16	0.8125	20.6375
53/64	0.828125	21.03437
27/32	0.84375	21.43125
55/64	0.859375	21.82812
7/8	0.875	22.225
57/64	0.890625	22.62187
29/32	0.90625	23.01875
59/64	0.921875	23.41562
15/16	0.9375	23.8125
61/64	0.953125	24.20937
31/32	0.96875	24.60625
63/64	0.984375	25.00312
1	1.0	25.4

Fasteners

Metric Fasteners

This vehicle provides fastener dimensions using the metric system. Most metric fasteners are approximate in diameter to equivalent English fasteners. Make replacements using fasteners of the same nominal diameter, thread pitch, and strength.

A number marking identifies the OE metric fasteners except cross-recess head screws. The number also indicates the strength of the fastener material. A Posidrive® or Type 1A cross-recess identifies a metric cross-recess screw. For best results, use a Type 1A cross-recess screwdriver, or equivalent, in Posidrive® recess head screws.

GM Engineering Standards and North American Industries have adopted a portion of the ISO-defined standard metric fastener sizes. The purpose was to reduce the number of fastener sizes used while retaining the best thread qualities in each thread size. For example, the metric M6.0 X 1 screw, with nearly the same diameter and 25.4 threads per inch replaced the English 1/4-20 and 1/4-28 screws. The thread pitch is midway between the English coarse and fine thread pitches.

Fastener Strength Identification

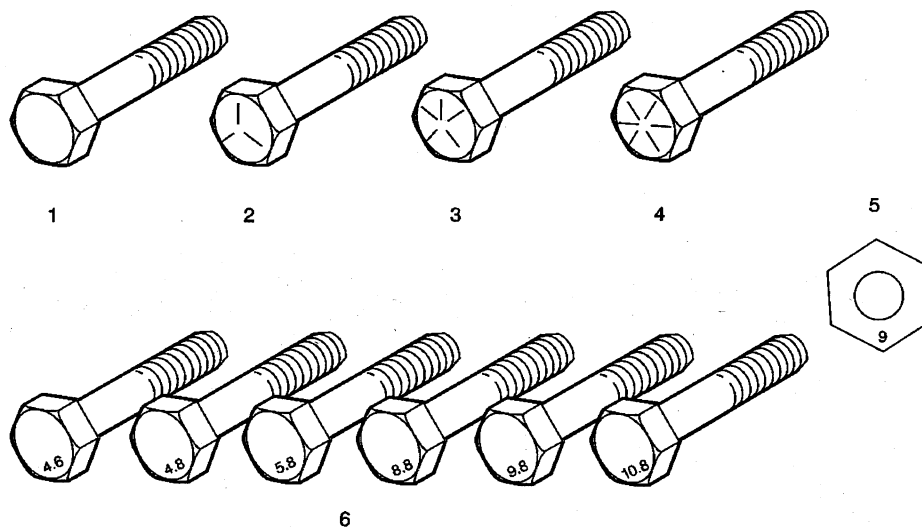

1. English Bolt, Grade 2 (Strength Class)
2. English Bolt, Grade 5 (Strength Class)
3. English Bolt, Grade 7 (Strength Class)
4. English Bolt, Grade 8 (Strength Class)
5. Metric Nut, Strength Class 9
6. Metric Bolts, Strength Class Increases as Numbers Increase

The most commonly used metric fastener strength property classes are 9.8 and 10.9. The class identification is embossed on the head of each bolt. The English, inch strength classes range from grade 2 to grade 8. Radial lines are embossed on the head of each bolt in order to identify the strength class. The number of lines on the head of the bolt is 2 lines less than the actual grade. For example, a grade 8 bolt will have 6 radial lines on the bolt head. Some metric nuts are marked with a single digit strength identification number on the nut face.

The correct fasteners are available through GM SPO. Many metric fasteners available in the aftermarket parts channels are designed to metric standards of countries other than the United States, and may exhibit the following:

- Lower strength
- No numbered head marking system
- Wrong thread pitch

The metric fasteners on GM products are designed to new, international standards. The following are the common sizes and pitches, except for special applications:

- M6.0 X 1
- M8 X 1.25
- M10 X 1.5
- M12 X 1.75
- M14 X 2.00
- M16 X 2.00

Prevailing Torque Fasteners

Prevailing torque fasteners create a thread interface between the fastener and the fastener counterpart in order to prevent the fastener from loosening.

All Metal Prevailing Torque Fasteners

These fasteners accomplish the thread interface by a designed distortion or deformation in the fastener.

Nylon Interface Prevailing Torque Fasteners

These fasteners accomplish the thread interface by the presence of a nylon material on the fastener threads.

Adhesive Coated Fasteners

These fasteners accomplish the thread interface by the presence of a thread-locking compound on the fastener threads. Refer to the appropriate repair procedure in order to determine if the fastener may be reused and the applicable thread-locking compound to apply to the fastener.

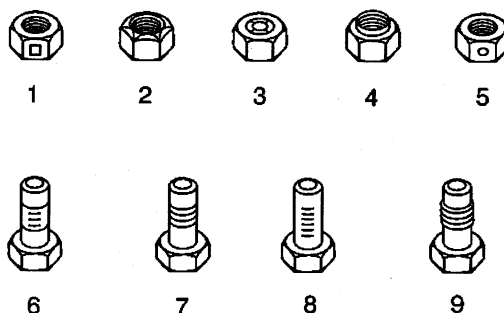

1. Prevailing Torque Nut, Center Lock Type

2. Prevailing Torque Nut, Top Lock Type
3. Prevailing Torque Nut, Nylon Patch Type
4. Prevailing Torque Nut, Nylon Washer Insert Type
5. Prevailing Torque Nut, Nylon Insert Type
6. Prevailing Torque Bolt, Dry Adhesive Coating Type
7. Prevailing Torque Bolt, Thread Profile Deformed Type
8. Prevailing Torque Bolt, Nylon Strip Type
9. Prevailing Torque Bolt, Out-of-Round Thread Area Type

A prevailing torque fastener may be reused ONLY if:

- The fastener and the fastener counterpart are clean and not damaged
- There is no rust on the fastener
- The fastener develops the specified minimum torque against its counterpart prior to the fastener seating

Metric Prevailing Torque Fastener Minimum Torque Development

Application	Specification	
	Metric	English
All Metal Prevailing Torque Fasteners		
6 mm	0.4 N·m	4 lb in
8 mm	0.8 N·m	7 lb in
10 mm	1.4 N·m	12 lb in
12 mm	2.1 N·m	19 lb in
14 mm	3 N·m	27 lb in
16 mm	4.2 N·m	37 lb in
20 mm	7 N·m	62 lb in
24 mm	10.5 N·m	93 lb in
Nylon Interface Prevailing Torque Fasteners		
6 mm	0.3 N·m	3 lb in
8 mm	0.6 N·m	5 lb in
10 mm	1.1 N·m	10 lb in
12 mm	1.5 N·m	13 lb in
14 mm	2.3 N·m	20 lb in
16 mm	3.4 N·m	30 lb in
20 mm	5.5 N·m	49 lb in
24 mm	8.5 N·m	75 lb in

English Prevailing Torque Fastener Minimum Torque Development

Application	Specification	
	Metric	English
All Metal Prevailing Torque Fasteners		
1/4 in	0.5 N·m	4.5 lb in
5/16 in	0.8 N·m	7.5 lb in
3/8 in	1.3 N·m	11.5 lb in
7/16 in	1.8 N·m	16 lb in
1/2 in	2.3 N·m	20 lb in
9/16 in	3.2 N·m	28 lb in
5/8 in	4 N·m	36 lb in
3/4 in	7 N·m	54 lb in
Nylon Interface Prevailing Torque Fasteners		
1/4 in	0.3 N·m	3 lb in
5/16 in	0.6 N·m	5 lb in
3/8 in	1 N·m	9 lb in
7/16 in	1.3 N·m	12 lb in
1/2 in	1.8 N·m	16 lb in
9/16 in	2.5 N·m	22 lb in
5/8 in	3.4 N·m	30 lb in
3/4 in	5 N·m	45 lb in